

4-156

Index
 File No. N-17
 T 4 S. 30 E. R.D. Ukiah County Umatilla Tract or Survey No. _____ Cor. No. _____
 Merid. Willamette N.F. Umatilla State Oregon

CORNER DIAGRAM

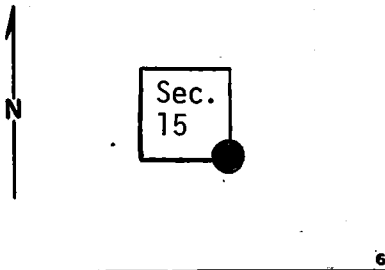

DESCRIBE CORNER MONUMENT FOUND

Basalt stone, 17"x12"x5", 7" above ground, fair condition. It appears that south and east edges have been notched (2 or 3 other stones in mound),
Monumented By BLM, 1978

DESCRIBE BEARING TREES OR OTHER OFFICIAL ACCESSORIES FOUND

A 13" western larch, down and rotting, bears N.55°E., approx. 40 ft. Some scribing visible.
 A 24" fir, down but still reasonably sound, bears S.48°E., approx. 27 ft. Scribing visible after removing bark.
 A 14" western larch bears S.70°W., approx. 8 ft. Blazes closed, but it appears to be B.T. It has old location poster.
No evidence of NW B.T.

DESCRIBE CORNER LOCATION RELATIVE TO NEAR-BY FEATURES, ALSO HOW TO REACH CORNER

Corner stone sets approx. 2 ft. north of fence corner (fence corner is a 22" white fir). Fence runs south and west. Location is near bottom of small drainage in a dense stand of (mostly) white fir. Some National Forest boundary posters along fence.

PHOTO IDENTIFICATION DATA

Photo No. _____
 Filed At. _____
 Object Ident. _____
 Ident. By _____
Signature

PLANE COORDINATE POSITION DATA

State _____ Zone _____
 X _____
 Y _____
 Estab. By _____
Agency

Signature T. Hollamon Title Eng. Tech. Division _____ Headquarters S.O. Date 5/16/74 7100-52-(3/68)

CORNER RECORD (PERPETUATION)

MONUMENT: DESCRIBE NEW MONUMENT SET, OR WORK DONE TO PRESERVE EXISTING MONUMENT

ACCESSORIES : DESCRIBE NEW BT'S WITNESS OBJECTS ETC. ESTABLISHED, OR WORK DONE TO PRESERVE EXISTING EVIDENCE

I placed blank B.T. tags on the three found B.T.'s. I also placed a location poster on a fence post approx. 1600' south of point where primitive road crosses fence.

Work Done By _____ Title _____ Date _____ State Registration No. or Agency _____

Certified Cor. Record Prepared ? Yes No Filed At: _____ Date _____

REMARKS

Index File No. T. R. M. Tract or Surv. No. Cor.