

4-124

Index File No. N-13 **CORNER RECORD (SEARCH)** (Ref. FSM 7151.4) Tract or Survey No. \_\_\_\_\_ Cor. No. \_\_\_\_\_  
 T 4 S. R. 30 E. R.D. Ukiah County Umatilla  
 Merid. Willamette N.F. Umatilla State Oregon

**CORNER DIAGRAM**

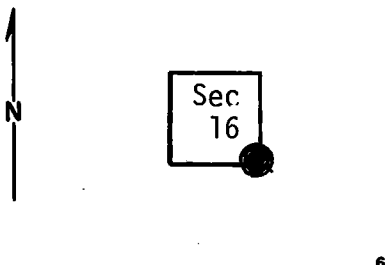

**DESCRIBE CORNER MONUMENT FOUND**  
 Stone mound. 2 or 3 stones only. 6" above ground; poor condition. No visible markings. Stone rock jack 5 ft. north may contain corner stone.  
*Monumented By BLM, 1978*

**DESCRIBE BEARING TREES OR OTHER OFFICIAL ACCESSORIES FOUND**  
 A p. pine 50" diam. bears N. 24°E., approx. 31 ft. Scribed T4S, R30E., S15, B.T. This tree has been struck by lightning, is over-mature and partly rotten but still alive.  
 A 24" p. pine bears N.45°W., approx. 5 ft. Part of scribing visible. The fence is fastened to this tree. This tree has location poster.

**PHOTO IDENTIFICATION DATA**

Photo No. \_\_\_\_\_  
 Filed At. \_\_\_\_\_  
 Object Ident. \_\_\_\_\_  
 Ident. By \_\_\_\_\_  
*Signature*

**DESCRIBE CORNER LOCATION RELATIVE TO NEAR-BY FEATURES, ALSO HOW TO REACH CORNER**  
 Location is approx. 50 ft. east of bottom of small drainage. Fences run east, west and north from corner location.

**PLANE COORDINATE POSITION DATA**

State \_\_\_\_\_ Zone \_\_\_\_\_  
 X \_\_\_\_\_  
 Y \_\_\_\_\_  
 Estab. By \_\_\_\_\_  
*Agency*

Signature	Title	Division	Headquarters	Date	7100-52-(3/68)
T. Hollamon	Eng. Tech.		S.O.	5/16/74	

CORNER RECORD (PERPETUATION)

MONUMENT: DESCRIBE NEW MONUMENT SET, OR WORK DONE TO PRESERVE EXISTING MONUMENT

ACCESSORIES : DESCRIBE NEW BT'S WITNESS OBJECTS ETC. ESTABLISHED, OR WORK DONE TO PRESERVE EXISTING EVIDENCE

I placed blank B.T. tags on the three standing B.T.'s.

Work Done By \_\_\_\_\_ Title \_\_\_\_\_ Date \_\_\_\_\_ State Registration No. or Agency \_\_\_\_\_

Certified Cor. Record Prepared ? Yes No Filed At: \_\_\_\_\_ Date \_\_\_\_\_

REMARKS

A fir, down and almost completely rotted; bears S.28<sup>0</sup>E., approx. 21 ft. Some scribing visible on a sliver remnant.  
A 26" p. pine bears S.46<sup>0</sup>W., approx. 37 ft. Scribed T4S, R30E, S21

Index File No. T. R. M. Tract or Surv. No. Cor.

N-13 45 30E