

Index
File No. N-11
T 45 R. 30E
Merid. Willamette

CORNER RECORD (SEARCH)

(Ref. FSM 7151.4)

Tract or Survey No. _____ No. _____
R.D. Ukiah County Umatilla
N.F. Umatilla State Oregon

CORNER DIAGRAM

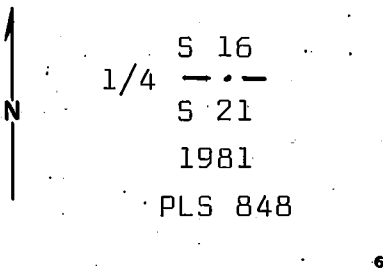

DESCRIBE CORNER MONUMENT FOUND

No evidence found. Fence construction and Maintenance over the years have destroyed all traces.

2

DESCRIBE BEARING TREES OR OTHER OFFICIAL ACCESSORIES FOUND

No bearing trees originally established. Set corner position by proportion.

PHOTO IDENTIFICATION DATA

Photo No. _____
Filed At _____
Object Ident. _____
Ident. By _____
Signature

DESCRIBE CORNER LOCATION RELATIVE TO NEAR-BY FEATURES, ALSO HOW TO REACH CORNER

Corner is on flat open ground approx. 30 ft. North of fence line. Follow fence line from East or West to the corner area.

PLANE COORDINATE POSITION DATA

State _____ Zone _____
X _____
Y _____
Estab. By _____
Agency

Title _____ Division _____ Headquarters _____ Date _____

PLS 848

Mt. Vernon, OR 9/80

7100-52-(3/68)

5

CORNER RECORD (PERPETUATION)

MONUMENT: DESCRIBE NEW MONUMENT SET, OR WORK DONE TO PRESERVE EXISTING MONUMENT

Set 3"x30" galv. iron pipe with 3" brass cap stamped as shown on the diagram. Set pipe 12 inches in the ground and raised a mound of stone around the pipe.

ACCESSORIES: DESCRIBE NEW BT'S WITNESS OBJECTS ETC. ESTABLISHED, OR WORK DONE TO PRESERVE EXISTING EVIDENCE

No bearing trees available.
Set steel posts with warning and boundary signs
5 ft. East and 5 ft. West from corner.

Work Done By D.M. Ferguson Title Surveyor Date 9/81 State Registration No. OR PLS 848
or Agency

Certified True Record Prepared? Yes No Filed At: Umatilla Co. Surveyor's Office Date

**PROFESSIONAL
LAND SURVEYOR**

REMARKS

Witnesses to above corner:

Dave Herburger
Dan Martin

OREGON
JULY 12, 1968
DOUGLAS M. FERGUSON
848

Index File No. N-11 **CORNER RECORD (SEARCH)** (Ref. FSM 7151.4) Tract or Survey No. _____ Cor. No. _____
 T 4 S. R. 30 E. R.D. Ukiah County Umatilla
 Merid. Willamette N.F. Umatilla State Oregon

CORNER DIAGRAM

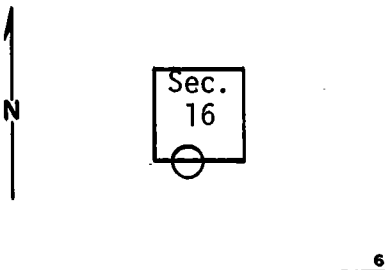

DESCRIBE CORNER MONUMENT FOUND

None 2

DESCRIBE BEARING TREES OR OTHER OFFICIAL ACCESSORIES FOUND

East-west fence line only. Original $\frac{1}{4}$ corner was a stone in a mound of stones. (No B.T.'s) There are several stone mounds (for fence support). I cannot identify corner. 3

PHOTO IDENTIFICATION DATA

Photo No. _____
 Filed At. _____
 Object Ident. _____
 Ident. By _____
Signature 7

DESCRIBE CORNER LOCATION RELATIVE TO NEAR-BY FEATURES, ALSO HOW TO REACH CORNER

4

PLANE COORDINATE POSITION DATA

State _____ Zone _____
 X _____
 Y _____
 Estab. By _____
Agency 8

Signature T. Hollamon Title Eng, Tech, Division _____ Headquarters S, O, Date 5/16/74 7100-52-(3/68) 5

CORNER RECORD (PERPETUATION)

MONUMENT: DESCRIBE NEW MONUMENT SET, OR WORK DONE TO PRESERVE EXISTING MONUMENT

ACCESSORIES : DESCRIBE NEW BT'S WITNESS OBJECTS ETC. ESTABLISHED, OR WORK DONE TO PRESERVE EXISTING EVIDENCE

Work Done By _____ **Title** _____ **Date** _____ **State Registration No.** _____
or Agency _____

Certified Cor. Record Prepared ? Yes No **Filed At:** _____ **Date** _____

REMARKS

Index File No. **T.** **R.** **M.** **Tract or Surv. No.** **Cor.**

9
10
11
12
13