

Index
File No. L-9

CORNER RECORD (SEARCH)

(Ref. FSM 7151.4)

Tract or

Survey No. _____

No. _____

T 45 R. 30ER.D. Ukiah

County

UmatillaMerid. WillametteN.F. Umatilla

State

Oregon

CORNER DIAGRAM

T45 R30E

1/4

S17 S16

1981

PLS 848

N

DESCRIBE CORNER MONUMENT FOUND

No evidence found. Fence running N-S & W.
Construction and maintenance of fence over the
years has destroyed the corner.

DESCRIBE BEARING TREES OR OTHER OFFICIAL ACCESSORIES FOUND

No trees originally taken.
Set corner position by proportion.

PHOTO IDENTIFICATION DATA

Photo No. _____

Filed At: _____

Object Ident. _____

Ident. By _____

Signature

PLANE COORDINATE POSITION DATA

State _____ Zone _____

X _____

Y _____

Estab. By _____

Agency

DESCRIBE CORNER LOCATION RELATIVE TO NEAR-BY FEATURES, ALSO HOW TO REACH CORNER

Corner is approx. 20 ft. N.W. from
N-S & W fence corner.
A N-S primitive road approx. 200 ft. West from corner.

Signature

Title

PLS 848

Division

Headquarters

Mt. Vernon, OR

Date

9/16/81

7100-52-(3/68)

5

CORNER RECORD (PERPETUATION)

MONUMENT: DESCRIBE NEW MONUMENT SET, OR WORK DONE TO PRESERVE EXISTING MONUMENT

Set 3"x30" galv. iron pipe with 3" brass cap stamped as shown on the diagram, set 14 inches in the ground and raised a mound of stone and earth around the pipe.

From which

ACCESSORIES : DESCRIBE NEW BT'S WITNESS OBJECTS ETC. ESTABLISHED, OR WORK DONE TO PRESERVE EXISTING EVIDENCE

A pine 11 in. dia. bears S20°W, 114.7 ft. scribed 1/4 S 17 BT.
A pine 9 in. dia. bears S63°E, 79.7 ft. scribed 1/4 S 16 BT.
Set steel posts with warning and boundary signs 5 ft. South and 5 ft. West from corner.
Nailed bearing tree signs and brass washers stamped PLS 848 to each tree.
Painted red band around each tree.

Work Done By D.M. Ferguson Title Surveyor Date 9/16/81 State Registration No. OR PLS 848
or Agency

~~Certified For Record Prepared~~ Yes No Filed At: Umatilla Co Surveyor's Office Date

PROFESSIONAL
LAND SURVEYOR

Douglas M. Ferguson
OREGON
JULY 12, 1968
DOUGLAS M. FERGUSON
848

REMARKS

Witnesses to above corner:

Dave Herburger
Larry Wyllie

Index
File No. L-9

CORNER RECORD (SEARCH)
(Ref. FSM 7151.4)

Tract or Survey No. _____
Cor. No. _____

T 4 S. R. 30 E. R.D. Ukiah County Umatilla

Merid. Willamette N.F. Umatilla State Oregon

CORNER DIAGRAM

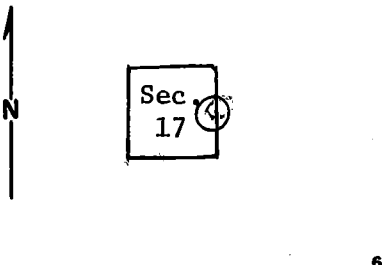

DESCRIBE CORNER MONUMENT FOUND

Fence corner only.

DESCRIBE BEARING TREES OR OTHER OFFICIAL ACCESSORIES FOUND

None. No corner evidence found. There is a fence corner at the assumed corner location. Fences run north, south and west from here -- no fence east.

PHOTO IDENTIFICATION DATA

Photo No. _____
Filed At. _____
Object Ident. _____
Ident. By _____
Signature

DESCRIBE CORNER LOCATION RELATIVE TO NEAR-BY FEATURES, ALSO HOW TO REACH CORNER

Road No. S-417 (to Gurdane) passes through east-west fence approx. 200' west of fence corner.

PLANE COORDINATE POSITION DATA

State _____ Zone _____
X _____
Y _____
Estab. By _____
Agency

There is a Forest Boundary sign where road passes through fence.

Signature _____ Title _____ Division _____ Headquarters _____ Date _____ 7100-52-(3/68)

T, Hollamon Eng, Tech, S, O, 4/12/74

CORNER RECORD (PERPETUATION)

MONUMENT : DESCRIBE NEW MONUMENT SET, OR WORK DONE TO PRESERVE EXISTING MONUMENT

ACCESSORIES : DESCRIBE NEW BT's WITNESS OBJECTS ETC. ESTABLISHED, OR WORK DONE TO PRESERVE EXISTING EVIDENCE

Work Done By _____ **Title** _____ **Date** _____ **State Registration No.** _____
or Agency _____

Certified Cor. Record Prepared ? Yes No **Filed At:** _____ **Date** _____

REMARKS

Index File No. **T.** **R.** **M.** **Tract or Surv. No.** **Cor.**