

CERTIFIED RECORD OF LAND CORNER MONUMENTATION

History of original corner establishment:

Corner not previously established.

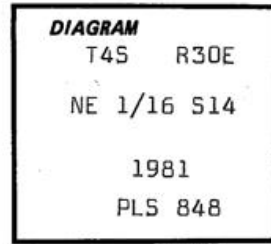

K-20

Description of corner evidence found:

N/A

Description of monument and accessories I established to perpetuate the original location of this corner:

Set 3"x30" galv. iron pipe with 3" brass cap stamped as shown on the diagram, set 16 inches in the ground and raised a mound of stone and earth around the pipe.

From which:

A pine 9 in. dia. bears N66°E, 35.1 ft. scribed NE 1/16 S 14 BT.

A pine 20 in. dia. bears N2°E, 34.0 ft. scribed NE 1/16 S 14 BT.

Set steel posts with warning and boundary signs 5 ft. West and 5 ft. North from corner. Nailed bearing tree signs and brass washers stamped PLS 848 to each tree.

Painted a red band around each tree.

I hereby certify that the above corner monument was established as herein described on 7/31/81.

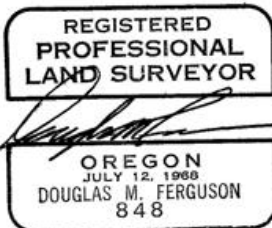

Witnesses:

D. Mitchell Ferguson

Mike Woodward

Office of.....C.O. Surveyor..... County of...Umatilla.....
 State of...Oregon....., I hereby certify that the within instrument was filed in this office
 for record on the...*10*... day of...*January*....., 19*82*
*David Rasmussen*..... by *Billy Shatto*.....
 (COUNTY OFFICIAL) (DEPUTY)

82-01-C

T-2

CERTIFIED RECORD OF LAND CORNER MONUMENTATION

History of original corner establishment:

Corner not previously established.

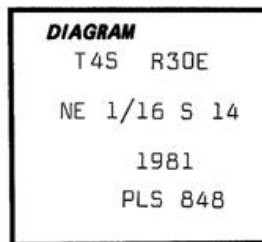

K-20

Description of corner evidence found:

N/A

Description of monument and accessories I established to perpetuate the original location of this corner:

Set 3"x30" galv. iron pipe with 3" brass cap stamped as shown on the diagram, set 18 inches in the ground and raised a mound of earth around the pipe.

From which:

A pine 22 in. dia. bears N6°E, 84.5 ft. scribed NW 1/16 S 14 BT.

A pine 12 in. dia. bears S19°W, 87.8 ft. scribed NW 1/16 S 14 BT.

Set steel posts with warning and boundary signs 5 ft. South and 5 ft. East from corner.

Nailed bearing tree signs and brass washers stamped PLS 848 to each tree. Painted red band around each tree.

I hereby certify that the above corner was established as herein described on 7/31/81.

Witnesses: D. Mitchell Ferguson

Mike Woodward

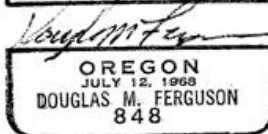
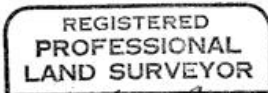

Office of..... Co. Surveyor..... County of...Umatilla.....
Oregon
State of....., I hereby certify that the within instrument was filed in this office
for record on the 7th day of January....., 19.82
David Krumbein by Betty Shatto
(COUNTY OFFICIAL) (DEPUTY)

82-1-B

T-2