

Index File No. J-9

CORNER RECORD (SEARCH)

Tract or Survey No. _____ No. _____

(Ref. FSM 7151.4)

T 4S R. 30E

R.D. Ukiah County Umatilla

Merid. Willamette

N.F. Umatilla State Oregon

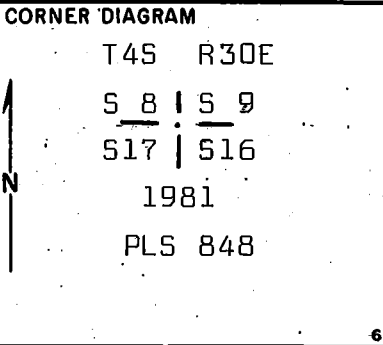

DESCRIBE CORNER MONUMENT FOUND

Found old mound of stone in fence corner. Mound does not appear to be a fence jack. No stones with marks visible.

2

DESCRIBE BEARING TREES OR OTHER OFFICIAL ACCESSORIES FOUND

Found old pine stump, burned and rotten, bears N26°W, 93 ft. from mound of stone. Due to harmony with found corners S & W, I accepted the mound of stone as the corner position.

3

PHOTO IDENTIFICATION DATA

Photo No. _____

Filed At _____

Object Ident. _____

Ident. By _____

Signature 7

DESCRIBE CORNER LOCATION RELATIVE TO NEAR-BY FEATURES, ALSO HOW TO REACH CORNER

Corner is in a N-S & W fence corner on flat open ground. A primitive road running N-S is approx. 300 ft. West from corner.

8

PLANE COORDINATE POSITION DATA

State _____ Zone _____

X _____

Y _____

Estab. By _____

Agency 8

Signature

Title PLS 848 Division _____ Headquarters Mt. Vernon, OR Date 9/16/81 7100-52-(3/68) 5

CORNER RECORD (PERPETUATION)

GPO 902-673

MONUMENT: DESCRIBE NEW MONUMENT SET, OR WORK DONE TO PRESERVE EXISTING MONUMENT

Set 3"x30" galv. iron pipe with 3" brass cap stamped as shown on the diagram, set 24 inches in the ground and placed a mound of stone around the pipe.

ACCESSORIES: DESCRIBE NEW BT'S WITNESS OBJECTS ETC. ESTABLISHED, OR WORK DONE TO PRESERVE EXISTING EVIDENCE

No bearing trees are available.
Set a steel post with warning sign, North alongside pipe.

Work Done By D.M. Ferguson Title Surveyor Date 9/16/81 State Registration No. OR PLS 848 or Agency

Certified Copy Record Prepared Yes No Filed At Umatilla Co Surveyor's Off Date

REGISTERED
PROFESSIONAL
LAND SURVEYOR

REMARKS

Witnesses to above corner:

OREGON
JULY 12, 1988
DOUGLAS M. FERGUSON
848

Dave Herburger
Larry Wyllie

Index File No.

T.

R.

M.

Tract or Surv. No.

Cor.

13

USDA-FOREST SERVICE

Index File No. J-9

CORNER RECORD (SEARCH)

(Ref. FSM 7151.4)

Tract or Survey No. _____ Cor. No. J-9

T 4S R. 30E

R.D. UKiah County _____

Merid. _____

N.F. _____ State _____

CORNER DIAGRAM

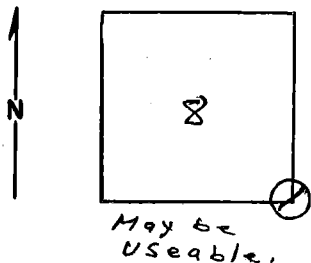

DESCRIBE CORNER MONUMENT FOUND

None. Rock Jack in fence corner only.

DESCRIBE BEARING TREES OR OTHER OFFICIAL ACCESSORIES FOUND

Badly deteriorated stump in approx. proper position for the only B&T.

PHOTO IDENTIFICATION DATA

Photo No. _____
Filed At. _____
Object Ident. _____
Ident. By _____
Signature

DESCRIBE CORNER LOCATION RELATIVE TO NEAR-BY FEATURES, ALSO HOW TO REACH CORNER

fences run North, South and West. faint evidence of old fence east

PLANE COORDINATE POSITION DATA

State _____ Zone _____
X _____
Y _____
Estab. By _____
Agency

Signature T. Hollaman

Title _____

Division _____

Headquarters _____

Date _____

4-17-80

7100-52-(3/68)

CORNER RECORD (PERPETUATION)

MONUMENT: DESCRIBE NEW MONUMENT SET, OR WORK DONE TO PRESERVE EXISTING MONUMENT

ACCESSORIES : DESCRIBE NEW BT'S WITNESS OBJECTS ETC. ESTABLISHED, OR WORK DONE TO PRESERVE EXISTING EVIDENCE

Work Done By _____ **Title** _____ **Date** _____ **State Registration No.**
or Agency _____

Certified Cor. Record Prepared ? Yes No **Filed At:** _____ **Date** _____

REMARKS

Index File No. _____ **T.** _____ **R.** _____ **M.** _____ **Tract or Surv. No.** _____ **Cor.** _____ **U.S. G.P.O. 1977-725-576/586**