

Index
File No. E-21

CORNER RECORD (SEARCH)

(Ref. FSM 7151.4)

Tract or
Survey No. _____ No. _____

T 4S R. 30E R.D. Uki h County Umatilla

Merid. Willamette N.F. Umatilla State Oregon

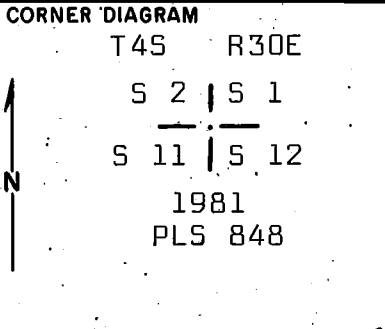

DESCRIBE CORNER MONUMENT FOUND

Original stone not found. Corner on a steep N.W. slope; corner stone has apparently eroded out and rolled down slope. A fire has gone through the area some 40-50 years ago.

DESCRIBE BEARING TREES OR OTHER OFFICIAL ACCESSORIES FOUND

Found 16 inch pine, dead and down, with BT scribing visible; tree has rolled down slope. There has been no substantial growth of tree since it was scribed. It is determined that this is the Sec 2 BT; therefore, corner is positioned at record call from original position of tree. No other bearing trees conclusive due to fire.

PHOTO IDENTIFICATION DATA

Photo No. _____

Filed At: _____

Object Ident. _____

Ident. By _____

Signature

DESCRIBE CORNER LOCATION RELATIVE TO NEAR-BY FEATURES, ALSO HOW TO REACH CORNER

Corner is on a steep (approx. 70%) slope in an old burn, top of slope is approx. 300 ft. SE from corner. A primitive road running generally E-W approx. 600 ft. South from corner on a level bench area.

PLANE COORDINATE POSITION DATA

State _____ Zone _____

X _____

Y _____

Estab. By _____

Agency

Signature _____ Title _____ Division _____ Headquarters _____ Date _____

PLS 848 Mt. Vernon, OR 8/11/81

CORNER RECORD (PERPETUATION)

MONUMENT: DESCRIBE NEW MONUMENT SET, OR WORK DONE TO PRESERVE EXISTING MONUMENT

Set 3"x30" galv. iron pipe with 3" brass cap stamped as shown on the diagram. Set 20 inches in the ground.

From which

ACCESSORIES: DESCRIBE NEW BT'S WITNESS OBJECTS ETC. ESTABLISHED, OR WORK DONE TO PRESERVE EXISTING EVIDENCE

A fir 12 inches dia. bears N9°E, 36.2 ft. scribed T4S R30E S 1 BT.
 A pine 10 inches dia. bears S14°E, 30.3 ft. scribed T4S R30E S 12 BT.
 A fir 15 inches dia. bears S39°W, 47.2 ft. scribed T4S R30E S 11 BT.
 A fir 8 inches dia. bears N56°W, 27.6 ft. scribed X BT.
 Set steel post with warning sign, 4 ft. North from corner.
 Nailed bearing tree signs and brass washers stamped PLS 848 to each tree.
 Painted a red band around each tree.

Work Done By D.M. Ferguson Title Surveyor Date 8/11/81 State Registration No. OR PLS 848
 or Agency

Certified Copy Required? Yes No Filed At: Umatilla Co. Surveyor Off. Date

PROFESSIONAL
LAND SURVEYOR

REMARKS

Witnesses to above corner:

OREGON
JULY 12, 1968
DOUGLAS M. FERGUSON
848

D. Mitchell Ferguson
Mike Woodward

Index File No.

T.

R.

M.

Tract or Surv. No.

Cor.

USDA-FOREST SERVICE

Index
File No. E-21

CORNER RECORD (SEARCH)

(Ref. FSM 7151.4)

Tract or Survey No. _____ Cor. No. _____

T 4S R. 30E. R.D. Ukiah County Umatilla

Merid. Willamette N.F. Umatilla State Oregon

CORNER DIAGRAM

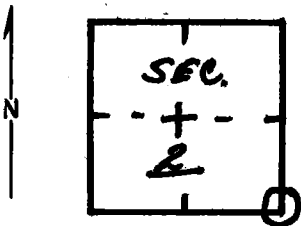

DESCRIBE CORNER MONUMENT FOUND

None.

DESCRIBE BEARING TREES OR OTHER OFFICIAL ACCESSORIES FOUND

None: Burnt stumps in area.

PHOTO IDENTIFICATION DATA

Photo No. _____

Filed At. _____

Object Ident. _____

Ident. By _____

Signature

PLANE COORDINATE POSITION DATA

State _____ Zone _____

X _____

Y _____

Estab. By _____

Agency

Signature

Title

Division

Headquarters

Date

7100-52-(3/68)

Bill Moore

Eng. Tech.

4/78

5

GPO 902-078

CORNER RECORD (PERPETUATION)

MONUMENT : DESCRIBE NEW MONUMENT SET, OR WORK DONE TO PRESERVE EXISTING MONUMENT

9

ACCESSORIES : DESCRIBE NEW BT'S WITNESS OBJECTS ETC. ESTABLISHED, OR WORK DONE TO PRESERVE EXISTING EVIDENCE

10

Work Done By _____ Title _____ Date _____ State Registration No.
or Agency _____

Certified Cor. Record Prepared ? Yes No Filed At: _____ Date _____

11

REMARKS

12

Index File No. T. R. M. Tract or Surv. No. Cor.

13