

USDA-FOREST SERVICE

Index
File No. Z-25
T 4S R. 29E
Merid. Willamette

CORNER RECORD (SEARCH)

(Ref. FSM 7151.4)

R.D. Ukiah County Morrow Tract or Survey No. S36
N.F. Umatilla State Oregon Cor. No. SE corner

CORNER DIAGRAM

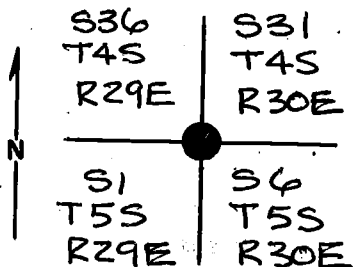

DESCRIBE CORNER MONUMENT FOUND

Found rotted remains of the original wood post buried in ground.

DESCRIBE BEARING TREES OR OTHER OFFICIAL ACCESSORIES FOUND

A dead and down tree bears N 62° E 12.5 feet \pm to stump hole with blaze rotted away.

A down and completely rotted tree bears S 34° E 13.9 feet \pm .
A rotted stump buried under needles bears N 45° W 5.3 feet \pm .
Old line trees run north, south, east and west from the corner.

DESCRIBE CORNER LOCATION RELATIVE TO NEAR-BY FEATURES, ALSO HOW TO REACH CORNER

Corner is located 700' south of intersection of Western Route Road and a jeep trail branching south. Location poster is on south side of road on top of cut bank.

PHOTO IDENTIFICATION DATA

Photo No. _____
Filed At. _____
Object Ident. _____
Ident. By _____
Signature

PLANE COORDINATE POSITION DATA

State _____ Zone _____
X _____
Y _____
Estab. By _____
Agency

Signature
William R. Wells

Title
PLS

Division

Headquarters

Date
8/21/79

7100-52-(3/68)

CORNER RECORD (PERPETUATION)

MONUMENT: DESCRIBE NEW MONUMENT SET, OR WORK DONE TO PRESERVE EXISTING MONUMENT

At the corner position a 2" x 30" iron pipe with brass cap was set 29" in the ground, marked:

Set a steel fence post by the corner and attached sign 54-4.

T4S
 R29E | R30E
 336 | S31
 51 | 56
 T5S
 PLS 1106

ACCESSORIES: DESCRIBE NEW BT'S WITNESS OBJECTS ETC. ESTABLISHED, OR WORK DONE TO PRESERVE EXISTING EVIDENCE

Established 4 new BT's:

A 9½" red fir bears N 8° E, 23.7 feet scribed T4S R30E S31BT,

An 8½" red fir bears S 31° E, 34.3 feet scribed T5S R30E S6BT.

A 7" tamarack bears S 54° W, 38.7 feet scribed T5S R29E S1BT.

A 9" red fir bears N 54½° W, 9.1 feet scribed T4S R29E S36BT.

New BT's have a lower blaze scribed BT with a brass washer stamped PLS 1106 nailed flush. Attached signs 54-3 and 54-4 to all BT's and painted red ring around trees above upper blaze. Location marker located on south side of road at top of cut bank 700 feet north of corner.

Work Done By William R. Wells Title PLS Date 8/21/79 State Registration No. 1106
or Agency

Certified Cor. Record Prepared? Yes No Filed At: Morrow County Surveyor's Office Date 11

REMARKS

Witnesses: R. D. English
B. J. Reynolds

USDA-FOREST SERVICE

Index
File No. A-25

CORNER RECORD (SEARCH)

(Ref. FSM 7151.4)

Tract or Survey No. _____ Cor. No. _____

T 5S R. 29E R.D. Ukiah County _____
Merid. Willamette N.F. Umatilla State Oregon

CORNER DIAGRAM

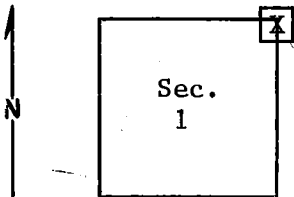

DESCRIBE CORNER MONUMENT FOUND

None

DESCRIBE BEARING TREES OR OTHER OFFICIAL ACCESSORIES FOUND

Rotted down tree - 3'x6" chunk with scribed: 6
10" pine, blazed 4 sides. blaze lines 4 ~~cardinal~~ directions.
Cardinal

PHOTO IDENTIFICATION DATA

Photo No. _____
Filed At. _____
Object Ident. _____
Ident. By _____
Signature

DESCRIBE CORNER LOCATION RELATIVE TO NEAR-BY FEATURES, ALSO HOW TO REACH CORNER

PLANE COORDINATE POSITION DATA

State _____ Zone _____
X _____
Y _____
Estab. By _____
Agency

Signature _____ Title _____ Division _____ Headquarters _____ Date 7100-52-(3/68)

Moore, Bill Eng, Tech 4/78

CORNER RECORD (PERPETUATION)

GPO 902-673

MONUMENT : DESCRIBE NEW MONUMENT SET, OR WORK DONE TO PRESERVE EXISTING MONUMENT

9

ACCESSORIES : DESCRIBE NEW BT'S WITNESS OBJECTS ETC. ESTABLISHED, OR WORK DONE TO PRESERVE EXISTING EVIDENCE

10

Work Done By _____ Title _____ Date _____ State Registration No. or Agency _____

Certified Cor. Record Prepared ? Yes No Filed At: _____ Date _____

REMARKS

12

Index File No. T. R. M. Tract or Surv. No. Cor. _____

13