

USDA-FOREST SERVICE

Index
File No. Z-23

CORNER RECORD (SEARCH)

(Ref. FSM 7151.4)

Tract or
Survey No. S36

Cor.
No. S $\frac{1}{4}$

T 4S R. 29E

R.D. Ukiah County

Morrow

Merid. Willamette

N.F. Umatilla State

Oregon

CORNER DIAGRAM

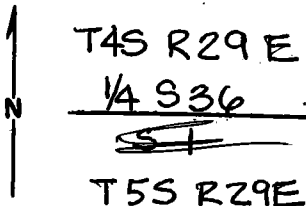

DESCRIBE CORNER MONUMENT FOUND

None. Corner set by survey.

Common to S36 only

DESCRIBE BEARING TREES OR OTHER OFFICIAL ACCESSORIES FOUND

None

PHOTO IDENTIFICATION DATA

Photo No. _____

Filed At. _____

Object Ident. _____

Ident. By _____

Signature

PLANE COORDINATE POSITION DATA

State _____ Zone _____

X _____

Y _____

Estab. By _____

Agency

DESCRIBE CORNER LOCATION RELATIVE TO NEAR-BY FEATURES, ALSO HOW TO REACH CORNER

Corner is located in a lodge pole patch on gradual west slope of a ridge.

William R. Webb

Signature

PLS Title

Division

Headquarters

Date
8/23/79

7100-52-(3/68)

CORNER RECORD (PERPETUATION)

MONUMENT: DESCRIBE NEW MONUMENT SET, OR WORK DONE TO PRESERVE EXISTING MONUMENT

At the corner position a 2 inch by 30 inch iron pipe, with brass cap marked as shown, was set 26 inches in ground with mound of earth and a trench. Set steel fence post on township line by corner and attached sign 54-4;

T4S R29E
~~S1~~
 1/4 S36
 T5S R29E
 1979
 PLS 1106

ACCESSORIES: DESCRIBE NEW BT'S WITNESS OBJECTS ETC. ESTABLISHED, OR WORK DONE TO PRESERVE EXISTING EVIDENCE

Established 2 new BT's:

A 7" red fir bears N 27° W, 39.0 feet scribed 1/4 S 36 BT.

A 6 1/2" red fir bears N 19° E, 15.0 feet scribed 1/4 S 36 BT.

New BT's have a lower blaze scribed BT with a brass washer stamped PLS 1106 nailed flush.

Attached signs 54-3 and 54-4 to all BT's and painted red ring around the trees above upper blaze.

Work Done By William R. Wells Title PLS Date 8/23/79 State Registration No. 1106
 or Agency
 Certified Cor. Record Prepared? Yes No Filed At: Morrow County Surveyor's Office Date _____

REMARKS

Witnesses: R. D. English
 B. J. Reynolds

Index File No. Z-23 T. 4S R. 29E M. Willamette Tract or Surv. No. S36 Cor. S1
 U.S. G.P.O. 1977-725-576/586