

USDA-FOREST SERVICE

Index
File No. R-9

CORNER RECORD (SEARCH)
(Ref. FSM 7151.4)

Tract or
Survey No. _____
Cor. No. _____

T 4N R. 38E
Merid. W

R.D. WW County Umatilla
N.F. Umatilla State OREGON

CORNER DIAGRAM

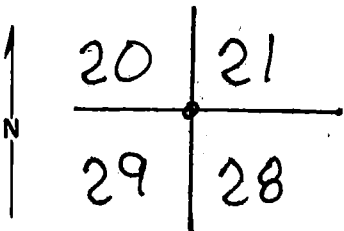

DESCRIBE CORNER MONUMENT FOUND

Found 2 1/2" Brass cap on 2" dia pipe; 11" exposed; no stones; CAP marked

US General Land Office Survey
Penalty \$250 For Removal
T4N R38E
S20 | S21

DESCRIBE BEARING TREES OR OTHER OFFICIAL ACCESSORIES FOUND

14" LP-PINE bears S38W at 4.4 ft scribed "4 38 2"
11" LP-PINE bears N71E at 12.4 ft scribed "38 E S"

S29 | S28
1939

PHOTO IDENTIFICATION DATA

Photo No. _____
Filed At. _____
Object Ident. _____
Ident. By _____
Signature _____

Dead & Down LP-PINE 5.5 ft scribed "4N 2"
Dead stump LP-PINE 6.5 ft scribed "T4N R38E S28 BT"

DESCRIBE CORNER LOCATION RELATIVE TO NEAR-BY FEATURES, ALSO HOW TO REACH CORNER

Drive to spur 060 junction with 6401 RD. Hike SW approx 300 ft to corner.

PLANE COORDINATE POSITION DATA

State _____ Zone _____
X _____
Y _____
Estab. By _____
Agency _____

Signature Colleen A Stryker

Title PHS

Division _____

Headquarters _____

Date 7/18/89

FS-7100-52 (3/68)

CORNER RECORD (PERPETUATION)

MONUMENT: DESCRIBE NEW MONUMENT SET, OR WORK DONE TO PRESERVE EXISTING MONUMENT

cleared area around monument

ACCESSORIES : DESCRIBE NEW BT'S WITNESS OBJECTS ETC. ESTABLISHED, OR WORK DONE TO PRESERVE EXISTING EVIDENCE

13" LP-Pine bears S42 E at 8.2 ft; scribed "T4N R38E S28 BT"
13" LP-Pine bears N15 W at 53.6 ft; scribed "T4N R38E S20 BT"
placed brass-washer PHS 2060 at base of both blazes

Work Done By E.A. Stryker Title OPHS Date 7/18/89 State Registration No. 2060
or Agency

Certified Cor. Record Prepared? Yes No Filed At: Umatilla Cty Date Aug 89

REMARKS

Painted Red Band around all BT's
Placed 54-3 signs (6) and 54-9 signs (4) on BT's
Placed 54-4 sign near corner
Placed 54-9 sign on steel fence post 0.9 north of cor

Index File No. T. R. M. Tract or Surv. No. Cor.
R-9 4N 38E W GPO: 1982 O-382-659

Index
 File No. R-9
 T 4 N R. 38 E
 Merid. Willamette

CORNER RECORD (SEARCH)
 (Ref. FSM 7151.4)

Tract or
 Survey No. Cor.
 No. R-9

R.D. Walla Walla County
 N.F. Umatilla State Oregon

CORNER DIAGRAM

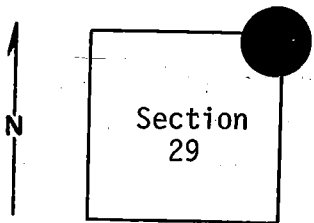

DESCRIBE CORNER MONUMENT FOUND 1

Brass Cap. Size: $2\frac{1}{2}$ ".
 1 foot above ground;
 good condition.

DESCRIBE BEARING TREES OR OTHER OFFICIAL ACCESSORIES FOUND 2

10" dead tree bears N 18° W, 5' distance from corner. South-
 east blaze scribed: 4N 20 B.T.
 14" L.Pine - S 30° W, 4' distance. Northeast blaze scribed
 inside.
 10" L.Pine - N 72° E, 13' distance. Southwest blaze scribed:
 38E, S21.

(cont. in block 12)

DESCRIBE CORNER LOCATION RELATIVE TO NEAR-BY FEATURES, ALSO HOW TO REACH CORNER 3

6 PHOTO IDENTIFICATION DATA

Photo No.
 Filed At.
 Object Ident.
 Ident. By
Signature

7 PLANE COORDINATE POSITION DATA

State Zone
 X
 Y
 Estab. By
Agency

Signature Title Division Headquarters Date 4

B. Moore Engineering Technician S. O. August 1975 7100-52-(3/68) 5

CORNER RECORD (PERPETUATION)

MONUMENT: DESCRIBE NEW MONUMENT SET, OR WORK DONE TO PRESERVE EXISTING MONUMENT

ACCESSORIES : DESCRIBE NEW BT'S WITNESS OBJECTS ETC. ESTABLISHED, OR WORK DONE TO PRESERVE EXISTING EVIDENCE

I placed Forest Service B.T. posters on the 4 bearing trees and location poster on road 300 feet east.

Work Done By _____ Title _____ Date _____ State Registration No. or Agency _____
Certified Cor. Record Prepared ? Yes No Filed At: _____ Date _____

REMARKS

(cont. from block 3)

10" x 18" high stump - S 51° E, 4' distance. Northwest blaze scribed: B.T.
Rest of bearing tree is on ground, blaze up, scribed: 4N, R38E.

Index File No. T. R. M. Tract or Surv. No. Cor. 12 13