

USDA-FOREST SERVICE

Index File No. RS

CORNER RECORD (SEARCH)

(Ref. FSM 7151.4)

Tract or Survey No. _____ Cor. No. _____

T 4N R. 38E

R.D. WW County UMATILLA

Merid. Will.

N.F. Umatilla State OREGON

CORNER DIAGRAM

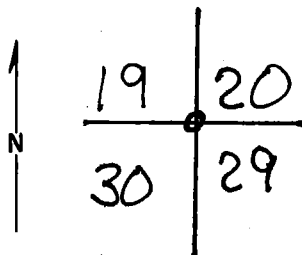

DESCRIBE CORNER MONUMENT FOUND

2 1/2" brass-cap on 2" iron pipe in stone mound with steel fence post on north. CAP MARKED!

US GENERAL LAND OFFICE SURVY PENALTY \$250 FOR REMOVAL
T4N R38E
S19 | S20
S30 | S29
1989

DESCRIBE BEARING TREES OR OTHER OFFICIAL ACCESSORIES FOUND

21" W-Larch bears N85E at 15.0 ft; healed blaze LP-PINE decayed bole (stump) bears S56E at 41.3 ft visible scribing "4N R38E S T"

LP-PINE stump moved by cat as blaze faces NW bears S26W at 16.8 ft scribed "30 BT"

PHOTO IDENTIFICATION DATA

Photo No. _____
Filed At. _____
Object Ident. _____
Ident. By _____
Signature _____

PLANE COORDINATE POSITION DATA

State _____ Zone _____
X _____
Y _____
Estob. By _____
Agency _____

DESCRIBE CORNER LOCATION RELATIVE TO NEAR-BY FEATURES, ALSO HOW TO REACH CORNER

Drive to 120 spur junction on G401 RD. Hike south to end 120 spur - then hike SW approx 800 ft to corner.

Signature Edwin A. Styer Title PHS Division _____ Headquarters _____ Date 7/18/89

CORNER RECORD (PERPETUATION)

MONUMENT: DESCRIBE NEW MONUMENT SET, OR WORK DONE TO PRESERVE EXISTING MONUMENT

cleared area around monument

ACCESSORIES: DESCRIBE NEW BT'S WITNESS OBJECTS ETC. ESTABLISHED, OR WORK DONE TO PRESERVE EXISTING EVIDENCE

11" true-fir bears N 19.5 W at 39.2 ft scribed "T4NR38E S19 BT"
 28" spruce bears S 52 W at 20.0 ft scribed "T4NR38E S30 BT"
 10" LP-PINS bears S 71 E at 10.7 ft scribed "T4NR38E S29 BT"
 placed brass washer P&S 2060 at base of each blaze

Work Done By F.A. Stryker Title DPWS Date 7/18/87 State Registration No. 2060
 or Agency

Certified Cor. Record Prepared? Yes No Filed At: Umatilla Cty Date Aug 87

REMARKS:

Painted all BT's with RED BAND
 Placed 54-3 signs (6) and 54-9 signs (4) on BT's
 Placed 54-4 sign (1) near corner
 Placed ~~54-1~~ and 54-2 signs on steel fence post 5 ft south of cor.

Index File No. T. R. M. Tract or Surv. No. Cor. 13
R-5 4N 38E W GPO: 1982 O-382-659

Index File No. R-5

CORNER RECORD (SEARCH)

(Ref. FSM 7151.4)

Tract or Survey No. _____

Cor. No. SEC. COR.

20

T 4 N R. 38 E

R.D. Walla Walla County Umatilla

Merid. Willamette

N.F. Umatilla State Oregon

CORNER DIAGRAM

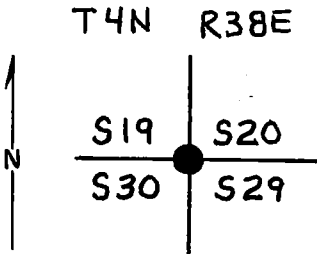

DESCRIBE CORNER MONUMENT FOUND

2" pipe with brass cap 8" high

DESCRIBE BEARING TREES OR OTHER OFFICIAL ACCESSORIES FOUND

None located

PHOTO IDENTIFICATION DATA

Photo No. _____

Filed At. _____

Object Ident. _____

Ident. By _____

Signature

DESCRIBE CORNER LOCATION RELATIVE TO NEAR-BY FEATURES, ALSO HOW TO REACH CORNER

12 ft. west of skid road. Has metal tag on Section line

between Sections 20 & 29.

PLANE COORDINATE POSITION DATA

State _____ Zone _____

X _____

Y _____

Estab. By _____

Agency



Signature W. G. Bosley

Title Forestry Tech. Timber

Division Walla Walla RD

Headquarters _____ Date 8/14/72

7100-52 (3/68)

CORNER RECORD (PERPETUATION)

MONUMENT: DESCRIBE NEW MONUMENT SET, OR WORK DONE TO PRESERVE EXISTING MONUMENT

9

ACCESSORIES : DESCRIBE NEW BT'S WITNESS OBJECTS ETC. ESTABLISHED, OR WORK DONE TO PRESERVE EXISTING EVIDENCE.

10

Work Done By _____ Title _____ Date _____ State Registration No. or Agency _____

Certified Cor. Record Prepared ? Yes No Filed At: _____ Date _____

11

REMARKS

12

Index File No. *P-5* T. R. M. Tract or Surv. No. Cor. 13