

Index
File No. J-25

CORNER RECORD (SEARCH)

Tract or
Survey No. _____ No. J-25

(Ref. FSM 7151.4)

T. 4N. R. 37ER.D. Walla Walla County _____Merid. W.M.N.F. Umatilla State Oregon

CORNER DIAGRAM

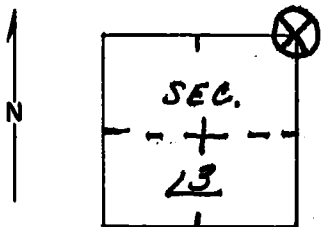

DESCRIBE CORNER MONUMENT FOUND

None

DESCRIBE BEARING TREES OR OTHER OFFICIAL ACCESSORIES FOUND

Old BT with scribing has slid down hill. An old BCC tag put up many years before & apparently prior to BT falling over indicates that a rotten stump still in place is position that the BT stood. This location also fits projected location for the corner based on accurate survey.

PHOTO IDENTIFICATION DATA

Photo No. _____

Filed At. _____

Object Ident. _____

Ident. By _____

Signature

PLANE COORDINATE POSITION DATA

State _____ Zone _____

X _____

Y _____

Estab. By _____

*Agency*Signature
*Raw*Title Forester Division B.C.C. Headquarters _____Date
9/14/76

7100-52-(3/68)

CORNER RECORD (PERPETUATION)

MONUMENT: DESCRIBE NEW MONUMENT SET, OR WORK DONE TO PRESERVE EXISTING MONUMENT

9

ACCESSORIES: DESCRIBE NEW BT'S WITNESS OBJECTS ETC. ESTABLISHED, OR WORK DONE TO PRESERVE EXISTING EVIDENCE

10

Work Done By _____ Title _____ Date _____ State Registration No. or Agency _____

Certified Cor. Record Prepared ? Yes No Filed At: _____ Date _____

11

REMARKS

12

Index File No. T. R. M. Tract or Surv. No. Cor.

13

Index
File No. J-1
T 4 N R. 38 E
Merid. Willamette

CORNER RECORD (SEARCH)

(Ref. FSM 7151.4)

Tract or Survey No. _____ Cor. No. _____
R.D. Walla Walla County Umatilla
N.F. Umatilla State Oregon

CORNER DIAGRAM

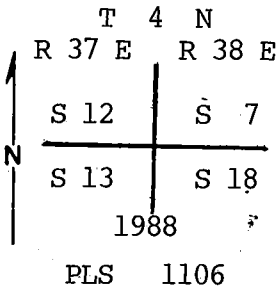

DESCRIBE CORNER MONUMENT FOUND

Found a basalt stone 18x9x5", with no visible marks, lying flat, and an axe sharpened post lying in ground from which:

DESCRIBE BEARING TREES OR OTHER OFFICIAL ACCESSORIES FOUND

Root hole bears N45°E, 113.5'. The tree from this root hole, size indeterminent, is located about 100' downhill with axe marks.

A 1984 Boise Cascade location poster is on a 15" ponderosa pine which brs N30°E, 1.5 chains from corner stone.

PHOTO IDENTIFICATION DATA

Photo No. _____
Filed At. _____
Object Ident. _____
Ident. By _____
Signature

DESCRIBE CORNER LOCATION RELATIVE TO NEAR-BY FEATURES, ALSO HOW TO REACH CORNER

Corner is located in snow brush near the East edge of a patch of timber.

PLANE COORDINATE POSITION DATA

State _____ Zone _____
X _____
Y _____
Estab. By _____
Agency

Signature

Will R. Wells

Title

Land Surveyor

Division

Headquarters

Pendleton, Or.

Date

8-24-88

FS-7100-52 (3/68)

CORNER RECORD (PERPETUATION)

MONUMENT: DESCRIBE NEW MONUMENT SET, OR WORK DONE TO PRESERVE EXISTING MONUMENT

At position of found stone...

Set 2½" aluminum cap on 2½" x 30" aluminum pipe 24" in ground to bedrock & surrounded with mound of earth & stone. Set 6' fence post North of corner with sign 54-4 attached. Cap marked as shown in corner diagram. Buried corner stone in mound.

Compass declination 19° East.

ACCESSORIES: DESCRIBE NEW BT'S, WITNESS OBJECTS ETC. ESTABLISHED, OR WORK DONE TO PRESERVE EXISTING EVIDENCE

New bearing trees established:

A 18" ponderosa pine brs N31½° E, 103.7' scribed T4NR38ES7 BT.

A 18" douglas fir brs S25½° E, 73.3' scribed T4NR38ES18 BT.

A 16" douglas fir brs S48° W, 57.1' scribed T4NR37ES13 BT.

A 9" douglas fir brs N90° W, 58.7' scribed T4NR37ES12 BT.

New bearing trees have a brass washer stamped PLS 1106 nailed to face of blaze. Attached sign 54-3 & 54-4 to each BT and painted face of blaze & 6" red band around each BT.

Work Done By W.R.Wells Title Land Surveyor Date 8-24-88 State Registration No. ORLS 1106
or Agency

Certified Cor. Record Prepared? Yes XXX Filed At: County Surveyor

Date

REMARKS

Index File No. J-25 T. 4 N R. 38 E W M.

Tract or Surv. No.

Cor.