

CERTIFIED RECORD OF LAND CORNER MONUMENTATION

F-3

History of original corner establishment:

None. Corner established with this survey.

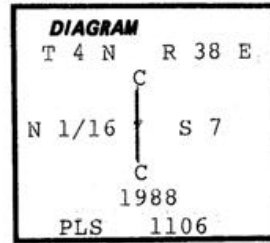

Description of corner evidence found:

None.

Description of monument and accessories established to perpetuate the original location of this corner:

At position determined by survey...

Set 2 1/2" aluminum cap on 2 1/2" x 30" aluminum pipe 10" in ground to bedrock & surrounded with mound of earth & stone. Set 6' fence post South of corner with signs 54-9 & 54-2 attached. Cap marked as shown in corner diagram.

New bearing trees established:

A 18" ponderosa pine brs N53 1/2° W, 63.8' scribed C-N1/16S7 BT.  
A 17" ponderosa pine brs S16 1/2° E, 137.0' scribed C-N1/16S7 BT.

New bearing trees have a brass washer stamped PLS 1106 nailed to face of blaze. Attached sign 54-3 & 54-9 to each BT and painted face of blaze & 6" red band around each BT.

Compass declination 15° East.

I hereby certify that the above described corner monument was properly established by me on September 1, 1988.

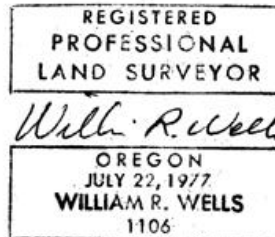

Office of...County...Surveyor..... County of...Umatilla.....  
State of...Oregon..... I hereby certify that the within instrument was filed in this office  
for record on the...17<sup>th</sup>...day of...October...1988  
David H. Klumbert... by...Kathleen Amstutz...  
(COUNTY OFFICIAL) (DEPUTY)

Form R6-7100-57 (9/71)

RECEIVED BY

Umatilla County Surveyor  
Date 10-88  
Rec'd By [Signature]  
No. 88-64-B