

OREGON CORNER RESTORATION FORM

Section 27,28 Township 4N Range 37E
County Umatilla Date 8/1/93
CORNER DESIGNATION: T-13

Previous Renewals/Surveys, etc. The original survey was made by George S. Pershin under contract No. 332, dated July 29th, 1879. He set a basalt stone 16 x 10 x 4 ins. in a mound of stone in a small open glade on a south slope for 1/4 Sec. Cor. from which:

A pine, 20 ins. diam. brs. N.26°E., 107 lks. dist.

A fir, 8" ins. diam. brs. N.74°W., 70 lks. dist.

As per corner record Q-726 Ferguson found a mound of stone in a small open glade on a south slope, and set a 5/8" x 30" steel pin with a plastic cap stamped LS 645 in the center of the mound from which: A pine 9" diam. brs. S.44°10'W., 74.05 ft. marked 1/4S S28 BT

A larch 8" diam brs. S.81°46'E., 93.19 ft. marked 1/4S S27 BT

Monument(s) & Accessories Found: (Condition and Source)

Found a mound of stones in a small open glade with a nail in the middle of it from which: A pine, 16" diam. with a closed blaze brs. S.44°W., 74.1 ft.

A larch, 14" diam. with a closed blaze brs. S.82°E., 93.2 ft.

We did not find the original stone.

Monument Detail:

T4N R37E
1
4
S28 | S27
1993
OR 1106

Monument Set (Procedures and Description): Set a 1/2" x 30" iron pipe with a 2 1/2" brass cap marked as indicated in the monument detail, 12" in the ground with a mound of stone to the top.

New Accessories: A 16" fir brs. S.28°E., 101.9 ft. marked T4N R37E S27 BT

A 18" fir brs. N.21°W., 51.7 ft. marked T4N R37E S28 BT

A steel fence post brs. S.75°E., 3.5 ft. with a Land Survey Monument sign attached.

Location & Comments: The corner is 25' W. of a logging road another mound of stone is 30' south with wire running through it.

Compass Declination: 18° E
Firm/agency: Tomkins-Wells Joint Venture
Land Surveying
P.O. Box 1696
Pendleton, Oregon 97801

Surveyor's Seal

Party Chief: Greg Flowers
Notes: Greg Flowers
Witness: Todd Rosenbalm

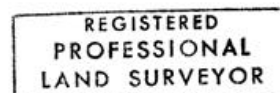

Will R. Wells
OREGON
JULY 22, 1977
WILLIAM R. WELLS
1106

expires 12-31-94

93-64-C