

CERTIFIED RECORD OF LAND CORNER MONUMENTATION

C-25

History of original corner establishment:

Corner established by George S. Pershin, U.S. Deputy Surveyor, under his Contract No. 304 dated September 19, 1878.

Surveyor General records state:

Set basalt stone 16 x 14 x 8 on rocky spur extending S.E. for 1/4 Sec. Cor. A fir 16 in. di. brs N46°W, 180 lks dis. No other tree.

Corner remonumented by Robert F. Omeg, U.S. Deputy Surveyor, under his Contract No. 761, dated June 16, 1905.

Surveyor General records state:

Set a basalt stone 16 x 14 x 8 ins 11 ins in the ground for 1/4 sec. cor. marked 1/4 on W face and raised a mound of stone 2 ft base and a 1 ft and a half high W of cor.

Description of corner evidence found:

Found basalt stone 18 x 12 x 8" on W side of a mound of stone (could not identify any marks on corner stone), from which:

A 10" douglas fir down and burnt bears N46°W, 105.5' to root hole with scribes "1/4 BT" visible.

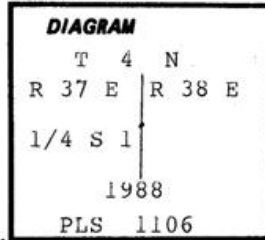

Description of monument and accessories established to perpetuate the original location of this corner:

At position of found stone....

Set 2 1/2" aluminum cap on 2 1/2" x 30" aluminum pipe 7" in ground to bedrock & surrounded with mound of earth & stone. Set 6' fence post South of corner with sign 54-4 attached. Cap marked as shown in corner diagram. Buried corner stone in mound.

No bearing trees are within usable limits. Marked bearing objects as follows:

A 10'x6' rock in place and projecting 6' out of ground marked "XBO" on E face brs S30°W, 40.6' distance.

A 2'x2' rock in place and projecting 2 1/2' out of ground marked "XBO" on E face brs N84°W, 62.8' distance.

Painted "XBO" marks in red.

Compass declination 19° East.

I hereby certify that the above described corner monument was properly remonumented by me on August 13, 1988.

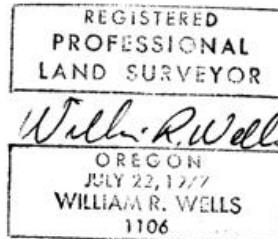

Office of... County Surveyor County of... Umatilla
 State of... Oregon I hereby certify that the within instrument was filed in this office
 for record on the 17 day of October 19 88
David H. Kumbier by Robert F. Amos
 (COUNTY OFFICIAL) (DEPUTY)

Form R6-7100-57 (9/71)

RECEIVED BY
 Umatilla County Surveyor
 Date 10-88
 Rec'd By R
 No. 88-64-B