

C. UNIFIED RECORD OF LAND CORNER MONUMENTATION

T 4N, R 36E., W.M.

Corner Code No. V-13

Note: Monument marked as shown below

History of original corner establishment:

This corner was originally established by William Odell, U.S. Deputy Surveyor, under Contract No. 114 dated July 2, 1866. The original notes state that at the corner a post was set from which:

- A 30" pine bears S37°E 119 lks.
- A 30" pine bears N1°E 106 lks.
- A 24" pine bears N69°W 144 lks.

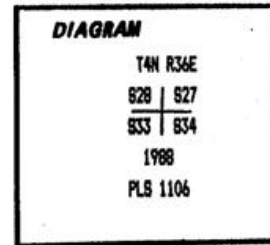

Corner No.
Compass Declination: 19.0°

Description of corner evidence found:

None, other than a north-south fence. The corner area has been farmed over for years.

Description of monument and accessories established to perpetuate the original location of this corner:

Reestablished corner position using the existing north-south fence for departure and a straight line between the found north one-quarter corner of Section 33 and the found northeast corner of Section 34 for latitude. Set a 2 1/2" brass cap on a 1 1/2" by 30" galv. iron pipe 28" in the ground and surrounded with a mound of earth. Since there are no trees near, I set two reference monuments as follows:
 A 1 1/2" plastic cap marked "W.R. Wells, PLS 1106", set on a 5/8" by 30" iron rod bears N1°E 33.4'. Set steel fence post with bearing object sign near the reference monument.
 A 1 1/2" alum. cap on a 5/8" by 30" iron rod bears S1°W 26.0', marked as shown below. Set steel fence post near the reference monument with bearing object sign attached.

Set steel fence post north of corner and attached witness corner sign.

The alum. cap on the SW reference monument is marked:

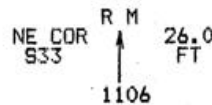

REGISTERED
PROFESSIONAL
LAND SURVEYOR

William R. Wells

OREGON
JULY 22, 1977
WILLIAM R. WELLS
1106

7-27-88

Office of Survey County of Umatilla
 State of OR, I hereby certify that the within instrument was filed in this office
 for record on the 28th day of July, 1988
 By David H. Keambler (COUNTY OFFICIAL) and William R. Wells (DEPUTY)

RECEIVED BY

Umatilla County Surveyor OP-780-278

Date 7-88
 Rec'd By [Signature]
 No. 88-42-C