

OREGON CORNER RESTORATION FORM

COUNTY: Umatilla DATE: 10/27/03

CORNER DESIGNATION: N-23, The North 1/4 Corner of Section 24, T4N, R36E, W.M..

PREVIOUS RENEWALS/SURVEYS ETC.: Corner originally established by Wm. Odell, under Contract No. 114, dated July 2, 1866. Notes state: Set post Cor. for 1/4 Sec. From which:
A Fir, 18 ins. diam brs. N 15°E., 7 lks.
A Larch, 6 ins. diam. brs. S88°E., 8 lks.

MONUMENT AND ACCESSORIES FOUND:

Found western larch bearing tree, now a 22" cut, rotted stump, 2 1/2' above ground, with scribing "BT" visible after opening blaze. Nothing remains of the Fir bearing tree.

MONUMENT MARKING DETAIL:

T4N R36E
S13
1/4 -----
S24
2003
PLS 1106

MONUMENT SET:

At a point North 88° West., 5.3' (8 lks) from face of blaze on western larch bearing tree stump, set a 2 1/2" brass cap on a 1 1/4" x 30" galvanized iron pipe 26" in the ground, surrounded with a mound of earth. Cap is marked as shown in "Monument Marking Detail".

New Accessories:

- A 12" fir bears N 81°E., 13.3' scribed "1/4 S13 BT".
- A 8" fir bears S 45°E., 33.9' scribed "1/4 S24 BT".
- A 6" Ponderosa pine bears S 14°W., 9.8' scribed "1/4 S24 BT".
- A 6" fir bears N 17°W., 17.0' scribed "1/4 S13 BT".

New bearing trees have a brass washer stamped "PLS 1106" nail to face of blaze, and a "bearing object" sign attached. Measurements to new bearing trees are to the center of tree.

Set steel fence post South of Corner monument and attached "witness" sign.

LOCATION AND COMMENTS: Corner falls on steep Northeast slope in second growth timber 30 to 50 feet high.

FIRM: William R. Wells, PLS
P.O. Box 1696
Pendleton, OR 97801

COMPASS DECLINATION: 18° East

Surveyor's Seal

Witnesses: Jason Wells, LSIT
Mark Hammersla

4N36N23

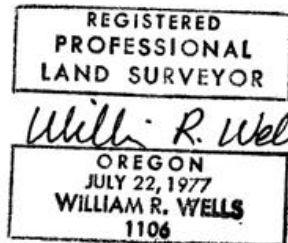

03-317-B