

OREGON COR RE ORATION FORM

COUNTY: Umatilla DATE: 06/18/97

CORNER DESIGNATION: T-9, The East Quarter Corner of Section 29, T4N., R35E., W.M.

PREVIOUS RENEWALS/SURVEYS, ETC.: Corner established by Wm. H. Odell, GLO Contract No. 114, dated July 2, 1866. Notes state: Set 1/4 Sec. Cor. post; drove charred stake, dug pits and raised mound as per instructions.

MONUMENT AND ACCESSORIES FOUND: None. Re-established corner position at the intersection of Key Cemetery Road and an established field line extending from the North.

MONUMENT MARKING DETAIL:

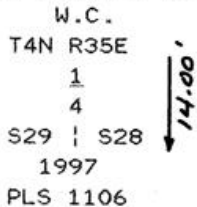

MONUMENT SET:

Corner position falls in a deep road cut subject to erosion and grading. At a point N 01°01'30" W, 14.00 feet from true corner. Set a 2 1/2" brass cap on a 1" x 30" galvanized iron pipe 12 inches below surface of cultivated field, monument marked as shown in monument marking detail.

New accessories (from witness corner monument):

A 5/8" x 24" iron rod with yellow plastic cap marked "OR PLS 1106, WA PLS 17372", bears N 78° E, 10.9 feet.

A 5/8" x 24" iron rod with yellow plastic cap marked "OR PLS 1106, WA PLS 17372", bears S 51° E, 35.5 feet.

A 5/8" x 24" iron rod with yellow plastic cap marked "OR PLS 1106, WA PLS 17372", bears S 46° W, 34.2 feet.

A 5/8" x 24" iron rod with yellow plastic cap marked "OR PLS 1106, WA PLS 17372" bears N 74° W, 14.0 feet.

Attached bearing object signs to all iron rods.

Iron rods in Southeast and Southwest Quadrants have steel fence post nearby with witness signs attached.

A 6" steel pipe 2.6 feet North of monument has a witness sign attached.

LOCATION & COMMENTS: Monument located approximately 2.6 feet North of a 6" steel pipe standing above ground 4 feet and 14 feet North of East x West dirt road (Key Cemetery Road).

COMPASS DECLINATION: 18° East

Surveyor's Seal

Witnesses: Kelly Snively  
Jason Wells

OREGON STATE PLANE NORTH CO-ORDINATE FOR CORNER, NAD 83(91), INT. FEET:

True corner:	Witness corner
N: 783312.12	14 feet North:
E: 8723110.92	N: 783326.10
	E: 8723110.31

REGISTERED PROFESSIONAL LAND SURVEYOR

*With: R. Wells*

OREGON JULY 22, 1977 WILLIAM R. WELLS 1106

*Renews 6-30-98*