

OREGON CORNER RESTORATION FORM

COUNTY: Umatilla DATE: 01/04/02

CORNER DESIGNATION: J-7, The North 1/4 Corner of Section 17.

PREVIOUS RENEWALS/SURVEYS ETC.: Corner originally established by Wm. H. Odell, under Contract No. 114, Dated July 2nd, 1866. Record states: Set post cor. for 1/4 Secs.; drove charred stake, dug pits and raised mound a per instructions. Corner was recovered and remonumented by J.C. Arnold, County Surveyor, under Survey No. 58, recorded at Record of Private Surveys Book 1, Page 264, in 1892. Arnold recovered the original corner stake and set a balloon shaped basalt rock 20 x 10 x 9", 18 " in the ground at the corner point.

MONUMENT AND ACCESSORIES FOUND: None. The area has been extensively farmed.

MONUMENT MARKING DETAIL:

T4N R35E
S8
1/4-----
S17
2002
PLS 1106

MONUMENT SET:

Reestablished corner by single proportionate measurement between the Northeast and Northwest corners of Section 18, using the J.C. Arnold 1892 survey record. At position determined by survey, set a 2 1/2" brass cap on a 1" x 30" galvanized iron pipe with cap buried 20" below ground level, marked as shown in monument marking detail. The corner location matches the Southerly projection of an ancient field berm located in the North Half of Section 8 within 4 feet.

From the new corner monument:

- A silver deep-1 magnet, buried 20" in ground, bears N 20 1/2° E, 21.7 feet.
- A purple deep-1 magnet, buried 20" in ground, bears S 22° E, 35.0 feet.
- A blue deep-1 magnet, buried 20" in ground, bears S 43 1/2° W, 42.1 feet.
- An orange deep-1 magnet, buried 20" in ground, bears N 50° W, 34.8 feet.
- Top of irrigation riser bears N 42 1/2° E, 64.8 feet.
- Buried bearing object signs alongside the deep-1 magnets.
- Attached witness post signs to steel fence posts by the irrigation riser accessory.

LOCATION AND COMMENTS:

The corner is located approximately 45 feet West of an irrigation riser line and field line which runs North/South. After consulting a 1939 aerial photograph of the area, I determine the irrigation riser line was constructed without reference to the North-South centerline of Section 8, based on J.C. Arnold survey dimensions and the location of the ancient North-South filed berm located to the North.

OREGON STATE PLANE COORDINATES, North Zone, NAD 83(91), International Feet:

N: 796587.69
E: 8720233.84

FIRM: William R. Wells, PLS
P.O. Box 1696
Pendleton, OR 97801

COMPASS DECLINATION: 18° East

Surveyor's Seal

Witnesses: Jason Wells, LSIT
Mark Hammersla
4N35J7

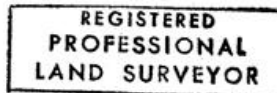

Will. R. Wells
OREGON
JULY 22, 1977
WILLIAM R. WELLS
1106

renews 6-30-02

02-12-c