

OREGON CORNER RESTORATION FORM

COUNTY: Umatilla DATE: 05/24/01

CORNER DESIGNATION: J-5, Northwest Corner of Section 17, T4N., R35E., W.M..

PREVIOUS RENEWALS/SURVEYS ETC.: Corner originally established by Wm. H. Odell, under Contract No. 114, dated July 2nd, 1866. Record states: Set post Cor. for Secs. 7, 8, 17 & 18; drove charred stake, dug pits and raised mound as per instructions. Corner remonumented by J. C. Arnold, County Surveyor, on Umatilla County Survey recorded at Book 1, Page 264. Record states: Found the charred end of the original sec. post, I set an alkali stone 15 x 9 x 4 ins., 15 ins. In ground, for sec. cor., mkd. 5 notches on E. edge and 4 notches on S. edge. Corner remonument by Krumbeln Engineering Ltd., on Umatilla County Survey No. 83-76-C. Record states: In 1973 Staebler found fence corner and has a signed statement that in the past there had been a marked stone that was dozed out, he set a 2" x 36" iron pipe, K.E.L. found 1 1/2" pipe set by Staebler and replaced pipe with brass cap monument.

MONUMENT AND ACCESSORIES FOUND:

Found a 2 1/2" brass cap monument set flush with the ground in triangle where two farmed fields meet. Brass cap is marked as shown in "Monument Marking Detail".

MONUMENT MARKING DETAIL:

T4N R35E
S7 | S8
S18|S17
1982
PLS 933

NEW ACCESSORIES FOR EXISTING MONUMENT:

- A silver deep-1 magnet buried 20" in the ground, bears N 18° E, 38.6 feet.
- A 5/8" x 30" iron rebar with a yellow plastic cap stamped "OR PLS 1106, WA PLS 17372", bears S 54° E, 48.4 feet.
- A 5/8" x 30" iron rebar with a yellow plastic cap stamped "OR PLS 1106, WA PLS 17372" bears S 13° E, 21.1 feet.
- A 5/8" x 30" iron rebar with a yellow plastic cap stamped "OR PLS 1106, WA PLS 17372" bears N 82° W, 25.0 feet.
- Set steel fence posts with witness post signs beside all 5/8" iron rebars with bearing object signs wired to rebars.
- Buried bearing object sign alongside deep-1 magnet.

LOCATION AND COMMENTS:

OREGON STATE PLANE CO-ORDINATES, North Zone, NAD 83 (91), International Feet:

N: 796464.25
E: 8717591.78

FIRM: William R. Wells, PLS
P.O. Box 1696
Pendleton, OR 97801

COMPASS DECLINATION: 18° East

Surveyor's Seal

Witnesses: Jason Wells, LSIT
Mark Hammersla

4N35J5

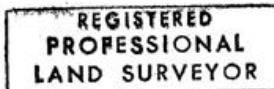

With: R. Wells

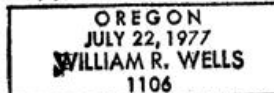

renews 6-30-02

02-12-e