

# OREGON CORNER RESTORATION FORM

COUNTY: Umatilla DATE: 05/24/01

CORNER DESIGNATION: J-15, North 1/4 Corner of Section 15, T4N., R35E., W.M..

PREVIOUS RENEWALS/SURVEYS ETC.: Corner originally established by Wm. H. Odell under Contract No. 114, dated July 2nd, 1866. Record states: Set post Cor. for 1/4 Sec. on level, drove charred stake, dug pits and raised mound as per instructions. Corner reestablished by Krumbein Engineering Ltd., on Umatilla County Survey No. 83-76-C. Record states: K.E.L. set B.C. based UPRR ties to corner.

## MONUMENT AND ACCESSORIES FOUND:

Found a 2 1/2" brass cap monument, 6" above ground level, just South of Highway 11, at the toe of road fill. The West edge of road bed for the old highway (heading South toward Weston) hits the toe of the new highway fill at this point. Cap is marked as shown in "Monument Marking Detail".

## MONUMENT MARKING DETAIL:

T4N R35E  
1/4 S10  
S15  
1983  
PLS 933  
U.C.S.

## NEW ACCESSORIES TO EXISTING MONUMENT:

An old steel fence post at toe of fill bears N 62 1/2°E, 49.2 feet.

A 5/8" x 30" iron rebar with yellow plastic cap stamped "OR PLS 1106, WA PLS 17372", flush with ground, bears S 48° E, 47.6 feet.

The angle brace at the end of the highway right-of-way fence bears S 05 1/2° W, 39.9 feet.

An "XBO" chiseled in large boulder half way up highway fill slope bears N 50 1/2° W, 9.5 feet.

Attached bearing object signs to all new accessories objects except "XBO". An existing steel fence post with witness post sign is 1.5 feet West of monument.

## LOCATION AND COMMENTS:

OREGON STATE PLANE CO-ORDINATES, Oregon North, NAD 83(91), International Feet:

N: 796914.82  
E: 8730868.56

FIRM: William R. Wells, PLS  
P.O. Box 1696  
Pendleton, OR 97801

COMPASS DECLINATION: 18° East

Witnesses: Jason Wells, LSIT  
Mark Hammersla  
V4N35J15

Surveyor's Seal

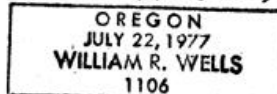
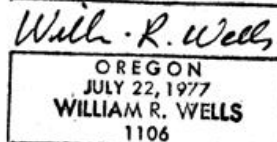
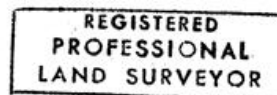

renews 6-30-02

02-12-e