

# OREGON CORNER RESTORATION FORM

## CORNER DESIGNATION: T4N, R34E, N-09

SOUTHEAST CORNER OF SECTION 17, TOWNSHIP 4 NORTH, RANGE 34 EAST, W.M.,  
UMATILLA COUNTY, OREGON.

## PREVIOUS RENEWALS / SURVEYS, ETC.:

T4N R34E WAS ORIGINALLY SUBDIVIDED BY U.S. DEPUTY SURVEYOR WILLIAM H. ODELL UNDER CONTRACT NO. 114 DATED JULY 2, 1866. THE NOTES READ, "SET POST CORNER FOR SECTIONS 16, 17, 20 & 21. DROVE CHARRED STAKE DUG PITS AND RAISED MOUND AS PER INSTRUCTIONS." COUNTY ROAD RECORDS FOR OLD ROAD NUMBERS 110 & 164, RECORDED IN 1882 AND 1884 RESPECTIVELY, CALL FOR THE ROADS TO FOLLOW THE SECTION LINES IN THIS AREA. SURVEY FOR OLD ROAD NO. 110 SET MILE MARKER POSTS ALONG THE EAST LINES OF SECTIONS 17 & 20. VARIOUS ODOT MAPS FOR HIGHWAY 334 SHOW THE ROAD INTERSECTION AT THIS CORNER LOCATION BUT NO ACTUAL CORNER REFERENCES ARE MADE. IN 2001, SURVEY NO. 01-073-B ESTABLISHED THE SECTION LINE BETWEEN SECTIONS 20 & 21 AND SET A BRASS CAP AND FOUR REFERENCE MONUMENTS AT THE NORTHEAST CORNER OF SECTION 20 AT INTERSECTION OF ROADS (HWY 334 AND SAND HOLLOW ROAD). SEE CORNER RECORD N-09 ASSOCIATED WITH THIS SURVEY. IN 2003, ODOT SURVEY NO. 04-079-B FOUND THE BRASS CAP AND REPORTED ADDITIONAL REFERENCE MONUMENTS. IN 2016, ODOT SURVEY 16-104-B DID NOT RECOVER THE BRASS CAP AND CALCULATED THE POSITION BASED UPON REFERENCES PROVIDED IN AFOREMENTIONED SURVEY 01-073-B.

## MONUMENT AND ACCESSORIES FOUND:

NO BRASS CAP RECOVERED. FOUND ALL 5/8" REBAR REFERENCES FROM SURVEY NO. 01-073-B AND TIED TWO ADDITIONAL ALUMINUM CAP REFERENCES REPORTED IN SURVEY NO. 04-079-B. THESE ARE FURTHER DETAILED IN THE REFERENCES AND DIAGRAM BELOW.

## MONUMENT AND ACCESSORIES SET:

NO MONUMENTS WERE SET. THE CORNER FALLS IN THE MIDDLE OF THE INTERSECTION OF HIGHWAY 334 (RECENTLY OVERLAYED) AND SAND HOLLOW ROAD. THE CORNER IS VERY WELL REFERENCED. I USED TIES TO THE TWO ODOT ALUMINUM CAPS FROM SURVEY NO. 04-049-B TO COMPUTE THE MISSING CORNER LOCATION. THESE PROVIDED A GREATER ACCURACY THAN THAT OF CORNER RECORD N-09 (01-073-B). THE RESULTING LOCATION ALSO CHECKS WELL WITH RECORD DISTANCES REPORTED IN CORNER RECORD N-09 (01-073-B). SEE BELOW FOR ADDITIONAL DETAILS.

## REFERENCES:

- (A) FOUND 5/8" IRON REBAR WITH 1-1/2" ODOT ALUMINUM CAP. USED TO COMPUTE CORNER LOCATION. SEE SURVEY NO. 04-079-B. COMPUTED CORNER BEARS S 81°59'03" E, 200.30'.
- (B) FOUND 5/8" IRON REBAR WITH 1-1/2" ODOT ALUMINUM CAP. USED TO COMPUTE CORNER LOCATION. SEE SURVEY NO. 04-079-B. COMPUTED CORNER BEARS N 80°00'21" E, 184.83'.
- (C) FOUND 5/8" IRON REBAR WITH RED PLASTIC CAP MARKED "PLS 54871", 0.4' UP. SEE CORNER RECORD N-09 (01-073-B). COMPUTED CORNER BEARS S 56°20'46" W, 64.72'.
- (D) FOUND 5/8" IRON REBAR WITH RED PLASTIC CAP MARKED "PLS 54871", FLUSH. SEE CORNER RECORD N-09 (01-073-B). COMPUTED CORNER BEARS S 45°47'21" E, 26.77'.
- (E) FOUND 5/8" IRON REBAR WITH RED PLASTIC CAP MARKED "PLS 54871", 0.7' UP. SEE CORNER RECORD N-09 (01-073-B). COMPUTED CORNER BEARS N 14°50'53" E, 41.61'.
- (F) FOUND 5/8" IRON REBAR WITH MELTED RED PLASTIC CAP, 0.4' UP. SEE CORNER RECORD N-09 (01-073-B). COMPUTED CORNER BEARS N 63°50'48" W, 79.95'.

## DIAGRAM:

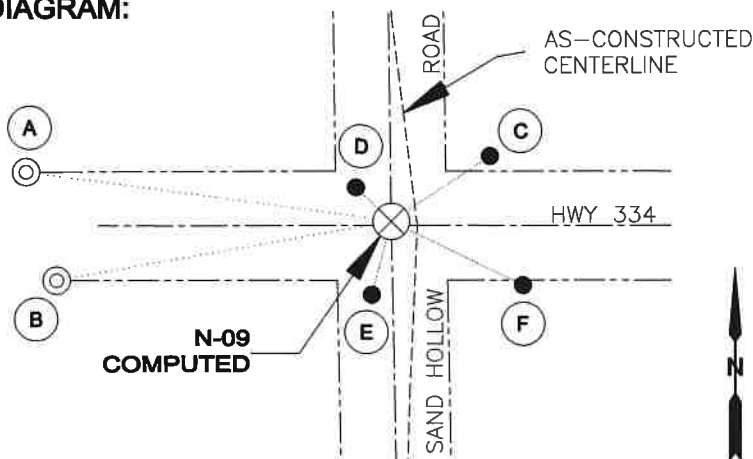

## LOCATION AND COMMENTS:

STATE PLANE COORDINATE  
NAD 83/91 OREGON NORTH ZONE  
N: 790,615.54 E: 8,691,460.47  
COMPUTED LOCATION AS SHOWN.

## COMPASS DECLINATION:

REPORTED BEARINGS ARE GRID  
CONVERGENCE ANGLE = 01°21'41"  
DECLINATION IS ±14°23' EAST  
CHANGING 6' WEST PER YEAR.

## FIRM/AGENCY:

UMATILLA COUNTY PUBLIC WORKS DEPARTMENT  
3920 WESTGATE, PENDLETON, OREGON 97801  
PARTY CHIEF: MATT KENNY  
WITNESS: TROY ALDERSON

**REGISTERED  
PROFESSIONAL  
LAND SURVEYOR**

*Matt Kenny*

OREGON  
JAN 12, 2016  
MATTHEW PATRICK KENNY  
89374PLS

RENEWALS: 6-30-21

19-108-C