

# OREGON CORNER RESTORATION FORM

**Section:** 1  
**Township:** 4 North  
**Range:** 32 East of the Willamette Meridian  
**County:** Umatilla  
**Date:** 02/13/02

**Corner Indexing Information:** Township 4N Range 32E Corner Code A-25 (Willamette Meridian)

**Additional Identifier:** (e.g. BLM designation for the corner, street intersection, plat name, block, lot, etc.)

**NE Corner Section 1 (Closing Corner)**

**Oregon Plane Coordinates:** N: 805441.072

**E:** 8649012.409

**Zone:** North **Order:** second **Datum:** NAD83-91 **Convergence:** 1°14'39.0" **Scale Factor:** 0.99988324

**Previous Renewals/Surveys, etc.:**

Corner was originally established in 1866 by Odell and Lewis under contract #110 as 1.05 chains West of the standard corner. The field notes make no mention of setting a monument.

No subsequent corner record exists.

**Monument(s) & Accessories Found (Condition & Source):**

Found an ancient 4"x 6" post 18" deep, with a broken steel post alongside, field lines to South and West.

**Monument Set (Procedures & Description):**

**Monument Detail:**

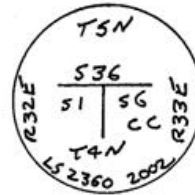
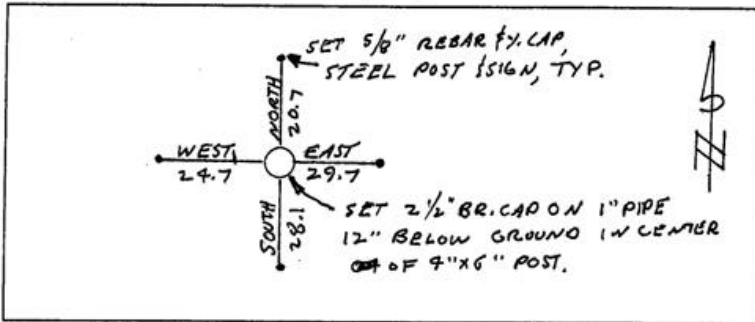

**Location & Comments:**

**Compass Declination:**

19° East

**Surveyor's Seal**

**Firm/Agency:** Tomkins Land Surveying, Inc.  
 20 E. Poplar, Suite 204  
 Walla Walla WA 99362

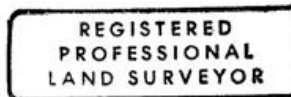

**Party Chief:** PWPT  
**Notes:**  
**Witness:** JLD

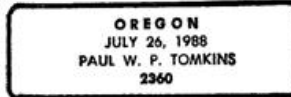

**RECEIVED BY**

Umatilla County Surveyor

Date 2-03

Rec'd By KE

No. 03-27-9