

OREGON CORNER RESTORATION FORM

Section: 33
Township: 4 North
Range: 32 East of the Willamette Meridian
County: Umatilla
Date: 04/19/02

Corner Indexing Information: Township 4N Range 32E Corner Code Z-9 (Willamette Meridian)

Additional Identifier: (e.g. BLM designation for the corner, street intersection, plat name, block, lot, etc.)

Southwest corner Section 33

Oregon Plane Coordinates: N: 773435.207 E: 8628535.660

Zone: North **Order:** second **Datum:** NAD83-91 **Convergence:** 1°11'07.2" **Scale Factor:** 0.99987355

Previous Renewals/Surveys, etc.:

This corner was originally established by Thompson in 1864 as a post, charred stake, mound, and pits, per contract no. 106.

In 1992, Monte Grove found a 3/4" iron pin (C.S. 93-29-C)

Monument(s) & Accessories Found (Condition & Source):

Found a 3/4" rebar 4" deep in center of East-West road.

Monument Set (Procedures & Description):

Monument Detail:

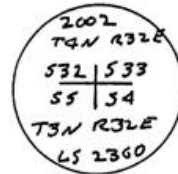
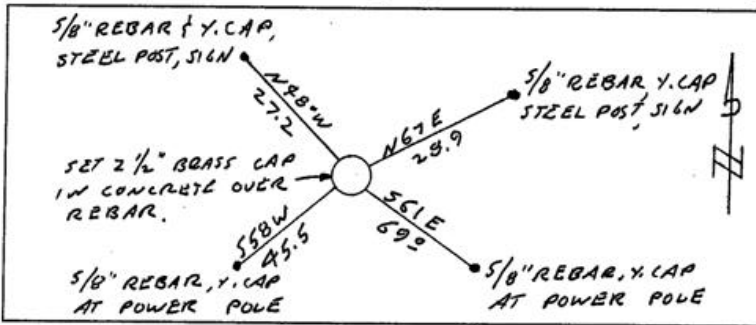

Location & Comments:

Compass Declination:

19° East

Surveyor's Seal

Firm/Agency: Tomkins Land Surveying, Inc.
 20 E. Poplar, Suite 204
 Walla Walla WA 99362

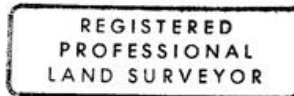

Party Chief: PWPT

Notes:

Witness:

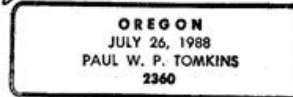

renews 6/30/04
2/11/03

RECEIVED BY

Umatilla County Surveyor

Date 2-03

Rec'd By KR

No. 03-28-9