

OREGON CORNER RESTORATION FORM

Section: 1  
Township: 4 North  
Range: 32 East of the Willamette Meridian  
County: Umatilla  
Date: 01/30/02

Corner Indexing Information: Township 4N Range 32E Corner Code A-23 (Willamette Meridian)

Additional Identifier: (e.g. BLM designation for the corner, street intersection, plat name, block, lot, etc.)

North 1/4 corner section 1

Oregon Plane Coordinates: N: 805392.714 E: 8646514.082

Zone: North Order: second Datum: NAD83-91 Convergence: 1°14'13.9" Scale Factor: 0.99988169

Previous Renewals/Surveys, etc.:

This corner was not set by G.L.O. survey as it is a closing corner on a standard parallel.

No subsequent history.

Monument(s) & Accessories Found (Condition & Source):

Found a locust post at North end of prominent field line.

Monument Set (Procedures & Description):

Monument Detail:

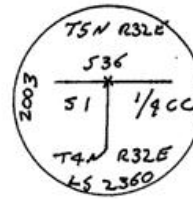
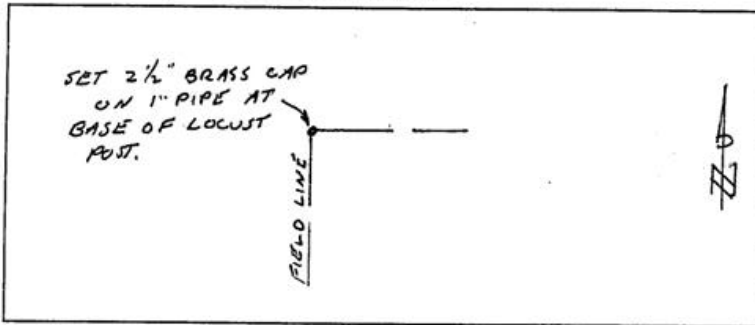

Location & Comments:

Compass Declination:

19° East

Surveyor's Seal

Firm/Agency: Tomkins Land Surveying, Inc.  
20 E. Poplar, Suite 204  
Walla Walla WA 99362

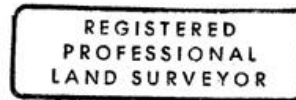

*Handwritten signature of Paul W. P. Tomkins*

Party Chief: PWPT

Notes:

Witness: JLO

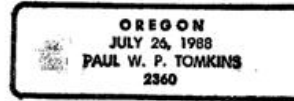

*renews 6/30/04*

*2/11/03*

RECEIVED BY

Umatilla County

Date 2-03

Rec'd By PK

No. 03-27-9