

OREGON CORNER RESTORATION FORM

Section 23 Township 4N Range 30E

County UMATILLA Date 5/26/04

CORNER DESIGNATION

R-17
(SOUTHWEST CORNER)

- Condition Report Only
- Not Found
- Renewed
- Unrecorded
- Surveyed In
- Referenced Out

Previous Renewals/Surveys, etc.:

DOLPHUS PAYNE, UNDER CONTRACT NO. 100, DATED AUGUST 1, 1861, SET CHARRED STAKE WITH MOUND, TRENCH AND PITS.
 DAVE KRUMBEIN SET A P-K NAIL AT THE INTERSECTION OF A NORTH-SOUTH FENCE LINE AND THE CENTER OF DESPAIN GULCH ROAD (SURVEY NO. I-162-B)

Monument(s) & Accessories Found: (Condition and Source)

NONE

Monument Detail

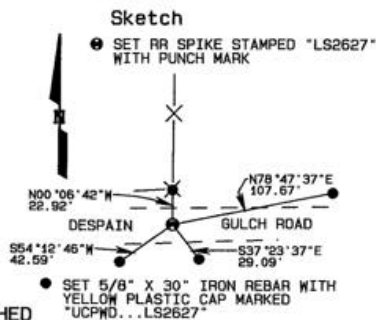

Monument Set (Procedures and Description):

AT THE INTERSECTION OF A NORTH-SOUTH FENCE LINE TO THE NORTH AND THE CENTER OF DESPAIN GULCH ROAD (FORMERLY ROAD NO. 199, ESTABLISHED ALONG THE SECTION LINE) SET A RAILROAD SPIKE STAMPED "LS2627" WITH PUNCH MARK FLUSH WITH PAVEMENT SURFACE.

New Accessories:

- A 5/8" IRON REBAR WITH YELLOW PLASTIC CAP MARKED "UCPWD...LS2627 BEARS N00°06'42"W, 22.92';
- A 5/8" IRON REBAR WITH YELLOW PLASTIC CAP MARKED "UCPWD...LS2627 BEARS N78°47'37"E, 107.67';
- A 5/8" IRON REBAR WITH YELLOW PLASTIC CAP MARKED "UCPWD...LS2627 BEARS S54°12'46"W, 42.59';
- A 5/8" IRON REBAR WITH YELLOW PLASTIC CAP MARKED "UCPWD...LS2627 BEARS S37°23'37"E, 29.09'

Location and Comments:

Compass Declination: N/A

Surveyor's Seal

CORNER IS LOCATED IN THE CENTER OF DESPAIN GULCH ROAD APPROXIMATELY 5 1/2 MILES EAST OF ITS INTERSECTION WITH NORTH LOOP ROAD AND 1 MILE WEST OF ITS INTERSECTION WITH KILGORE ROAD.

Firm/Agency :
UMATILLA COUNTY
ROAD DEPARTMENT

Address:
3920 WESTGATE
PENDLETON, OREGON

Party Chief:
GARY ROBERTS
Notes:
GARY ROBERTS
Witness:
NONE

REGISTERED
PROFESSIONAL
LAND SURVEYOR

Gary R. Roberts
OREGON
JULY 20, 1993
GARY R. ROBERTS
2627

RENEWS 12/31/2004