

GPS CONTROL STATION

OREGON STATE PLANE, NORTH ZONE

STATION NAME: 4N29V5 GEODETIC COORDINATE: NAD 83(91)

SECTION: SW COR S29 LAT: 45°47'28.79733" N  
T. 4N., R. 29 E., W. M. LONG: 119°13'32.65730" W  
UMATILLA COUNTY  
OREGON

STATE PLANE CO-ORDINATES,  
NAD 83-91, INT. FT. :

DATE SURVEYED: March, 1998

N: 777176.364

SURVEYOR: DAVID L. HADDOCK  
PLS 852

E: 8527133.277

THETA: 0°54'13.28"

SCALE FACTOR: 0.99995436

ELEV: 655

FIRM: HADDOCK SURVEYING  
P. O. BOX 1574  
PENDLETON, OR 97801  
(541) 276-2174

ELEV. DATUM: NGVD29

HORIZONTAL SECOND ORDER,  
ORDER: CLASS I

---

LOCATION: In the City of Stanfield at the Public High School. The cap is at the west end of the hedge row along the north end of the school's track.

STATION: Station is a 3 1/2 inch brass disc in a 9 inch concrete cylinder approximately 5 inches above the surface of the ground.

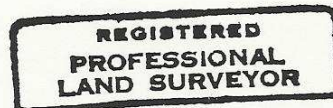

*David L. Haddock*

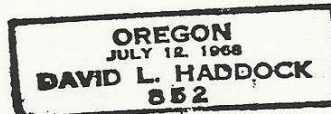

GPS CONTROL STATION

OREGON STATE PLANE, NORTH ZONE

STATION NAME: 4N29V5 GEODETIC COORDINATE: NAD 83(91)

SECTION: SW COR S29 LAT: 45°47'28.79733" N  
T. 4N., R. 29 E., W. M. LONG: 119°13'32.65730" W  
UMATILLA COUNTY  
OREGON

STATE PLANE CO-ORDINATES,  
NAD 83-91, INT. FT. :

DATE SURVEYED: March, 1998

N: 777176.364

E: 8527133.277

SURVEYOR: DAVID L. HADDOCK  
PLS 852

THETA: 0°54'13.28"

SCALE FACTOR: 0.99995436

ELEV: 655

FIRM: HADDOCK SURVEYING  
P. O. BOX 1574  
PENDLETON, OR 97801  
(541) 276-2174

ELEV. DATUM: NGVD29

HORIZONTAL ORDER: SECOND ORDER,  
CLASS I

---

LOCATION: In the City of Stanfield at the Public High School. The cap is at the west end of the hedge row along the north end of the school's track.

STATION: Station is a 3 1/2 inch brass disc in a 9 inch concrete cylinder approximately 5 inches above the surface of the ground.

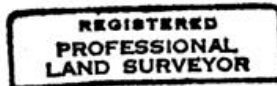

*David L. Haddock*

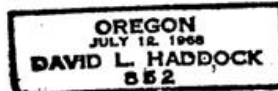

98-155-c