

OREGON CORNER RESTORATION FORM

SECTION: 10 TOWNSHIP: 4N RANGE: 29E J-15

COUNTY: UMATILLA DATE: 8/2011

CORNER DESIGNATION

S ¼ SECTION 10

- CONDITION REPORT ONLY**
- NOT FOUND**
- RENEWED**
- UNRECORDED**
- SURVEYED IN**
- REFERENCED OUT**

PREVIOUS RENEWALS/SURVEYS ETC.

Originally surveyed by T. Davenport under Contract # 101 in 1861. He set post with charred stake and made mound.

MONUMENTS AND ACCESSORIES FOUND: CONDITON AND SOURCE

Nothing found (cultivated fields and graveled road).

MONUMENT DETAIL

T4N R29E
10
¼
15
2011
LS 951

MONUMENT SET (PROCEDURES AND DESCRIPTION)

By single proportion I set a 1"x 30" flared iron pipe with a 2 3/8" brass cap stamped as above. Set at the surface and placed stones around. See my August 2011 boundary line adjustment survey for H.T. Burns, INC.

NEW ACCESSORIES FROM WHICH

- A 5/8" x 30" Iron Rebar with plastic cap #951 bears S 89° 29' 35" W Along Sec. Line 518.03' just west of metal pivot stop.
- A 5/8" x 30" Iron Rebar with plastic cap #951 bears N 36° 14' 20" E 92.02' in C/L graveled Rd.
- A 5/8" x 30" Iron Rebar with plastic cap #951 bears S 69° 50' 03" E 150.90' @ power pole.
- A 5/8" x 30" Iron Rebar with plastic cap #951 bears S 4° 27' 42" E 50.97' @ fence line

LOCATION AND COMMENTS

From the intersection of Edwards Road with East Highland Extension go East on East Highland Extension 1.5 miles to corner on North side of road and just West of a small center pivot.

SURVEYOR'S SEAL

FIRM: EDWARDS SURVEYING LLC
PO BOX 763 - HERMISTON OR 97838

PARTY CHIEF: G. Dennis Edwards
WITNESS: Rick Smith

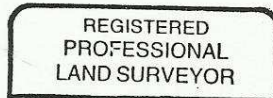

G. Dennis Edwards

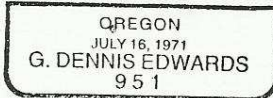

RENEWS 12/31/11