

USDA-FOREST SERVICE

Index File No. A-15

T 3S R. 33E

Merid. Willamette

CORNER RECORD (SEARCH)

(Ref. FSM 7151.4)

R.D. Ukiah County Umatilla

N.F. Umatilla State Oregon

Tract or Survey No. _____ Cor. No. 1/4

CORNER DIAGRAM

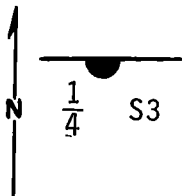

DESCRIBE CORNER MONUMENT FOUND

At corner position found original stone 15"x9"x7" - 3" in ground with visible "1/4" on North face and mound of stones 10" high and 24" dia. with post 2"x2"x48".

DESCRIBE BEARING TREES OR OTHER OFFICIAL ACCESSORIES FOUND

Found S.W. B.T. A Fir 23" dia. with healed over blazes.

PHOTO IDENTIFICATION DATA

Photo No. _____

Filed At. _____

Object Ident. _____

Ident. By _____

Signature

PLANE COORDINATE POSITION DATA

State _____ Zone _____

X _____

Y _____

Estab. By _____

Agency

DESCRIBE CORNER LOCATION RELATIVE TO NEAR-BY FEATURES, ALSO HOW TO REACH CORNER

Corner falls on steep N.W. slope approximately 75' West of West edge of large clearing.

Signature

Title

Division
O. RLS.

Headquarters
1294

Date
9/77

7100-52 (3, 68)

CORNER RECORD (PERPETUATION)

T2S R33E

MONUMENT: DESCRIBE NEW MONUMENT SET, OR WORK DONE TO PRESERVE EXISTING MONUMENT

In place of original stone:

$\frac{1}{4}$ S3

Set 2½"x30" Galvanized Pipe with Brass Cap Stamped:

T3S R33E

Set pipe 22" in ground with mound of stone to cap.

1980

OR PLS 1294

ACCESSORIES: DESCRIBE NEW BT'S WITNESS OBJECTS ETC. ESTABLISHED, OR WORK DONE TO PRESERVE EXISTING EVIDENCE

Old Trees: A Douglas Fir 23" dia. bears S24⁰W, 25.7 ft. with healed over blazes.

New Trees: A Douglas Fir 15" dia. bears S55⁰E, 17.1 ft., scribed 1/4 S3 BT.

Attached 54-3 & 54-4 signs to all BTs. Attached brass washer stamped LS 1294 to foot blaze of new BTs. Painted blazes and 6" band around both BTs. red.

Attached 54-2 and 54-4 signs to metal post 5' west of corner.

Work Done By R.C. Orton Title Party Chief Date 6/30/80 State Registration No. or Agency _____

Certified Cor. Record Prepared? Yes No Filed At: _____ Date _____

REMARKS

Witnesses: R. Orton
D. Allen
L. Huntsman

Index File No. T. R. M. Tract or Surv. No. Cor.

A-15. 3S 33E

BW-13

Index File No. A-15
T 3 S R. 33 E
Merid. Will.

CORNER RECORD (SEARCH)

Tract or Survey No. 22
Cor. No. A-15-5

R.D. Ukiah County Umatilla
N.F. Umatilla State Oregon

CORNER DIAGRAM

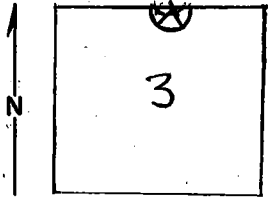

DESCRIBE CORNER MONUMENT FOUND

Original stone, 15" x 9" x 7", 15" above ground
Marked "1/4" on N. face.

DESCRIBE BEARING TREES OR OTHER OFFICIAL ACCESSORIES FOUND

22" DBH- Fir S 19 W, 39 lbs.
Blaze healed over.
Mound of rocks 12" high x 24" diameter. with
apost 2" x 2" x 48".

PHOTO IDENTIFICATION DATA

Photo No. EQO, 8-98(9-3-66)
Filed At. _____
Object Ident. 30" Fir, N37E, 5.19
Ident. By Tom Sullivan
Signature

DESCRIBE CORNER LOCATION RELATIVE TO NEAR-BY FEATURES, ALSO HOW TO REACH CORNER

Corner is 1 ch W. of a clearing which runs
to the top of the hill.
A Blazed line runs W. to section corner.

PLANE COORDINATE POSITION DATA

State _____ Zone _____
X _____
Y _____
Estab. By _____
Agency

Signature: Kent Magoun

Title Eng. Aide Division USFS Headquarters Umatilla-S.O. Date 8-5-69

CORNER RECORD (PERPETUATION)

MONUMENT: DESCRIBE NEW MONUMENT SET, OR WORK DONE TO PRESERVE EXISTING MONUMENT

ACCESSORIES: DESCRIBE NEW BT'S, WITNESS OBJECTS ETC. ESTABLISHED, OR WORK DONE TO PRESERVE EXISTING EVIDENCE

Painted red ring around corner stone.

Painted "BT" on BT.

Put a BT tag (54-3) and an Attention poster (54-4) on the BT.

Put a location poster (458) on a 6" Juniper along the fence running N+S along Red Saddle Ridge, 13 ch. E of corner and 12 ch. N. of where Fence intersects E-W Bdry fence.

Work Done By Mike Lilly Title EA & Aid Date State Registration No. US Forest Services
or Agency

Certified Cor. Record Prepared? Yes No Filed At: Date

REMARKS

Found corner by walking along compass line E. from section corner.

Index File No. A-15 T. 3S R. 33E M. Will Tract or Surv. No. Cor. A15