

CERTIFIED RECORD OF LAND CORNER MONUMENTATION

Index File No. A-11

History of original corner establishment:

In 1882, under G.L.O. contract No. 451, Rufus S. Moore set a basalt stone 15x10x5 ins. - 10 ins. in ground for 1/4 Sec. Corner, marked 1/4 on north face, from which a Pine 26" dia. bears S40°E, 149 lks dist., marked 1/4S BT. A Fir 15 ins. dia. bears N12°E, 52 lks dist., marked 1/4S BT.

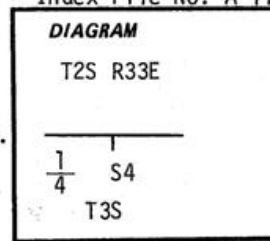

Description of corner evidence found:

At corner position found 15"x11"x5" stone with "1/4" on north face in mound of stone. Also, found Ponderosa Pine 36" dia. with healed over blaze opened to expose scribing "1/4S". No evidence remains of NE BT.

Description of monument and accessories | established to perpetuate the original location of this corner:

In place of original stone set 2 1/2"x30" galvanized pipe with brass cap stamped:

Set pipe 24" in ground with mound of stone to cap and original stone buried alongside.

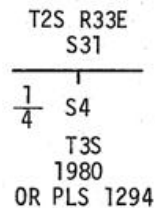

Bearing Trees:

Old BT: Ponderosa Pine 36" dia. bears S40°E, 99.5 ft with visible scribing "1/4S".  
 New BT: A Douglas Fir 12" dia. bears S26°E, 20.8 ft scribed 1/4 S4 BT.  
 A Douglas Fir 10" dia. bears S33°W, 11.6 ft scribed 1/4 S4 BT.

Attached 54-3 & 54-4 signs to all BT's. Attached brass washer stamped LS1294 to foot blaze of new BT's. Painted blazes and 6" band around both BT's red. Attached 54-4 sign to metal post 6' west of corner.

I hereby certify the above corner monument was re-established as herein described on July 29, 1980.

Witnesses: R. Orton  
 L. Huntsman  
 D. Allen

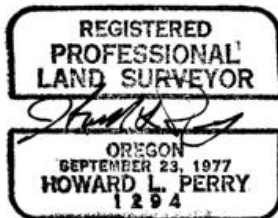

Office of..... County Surveyor..... County of..... Umatilla  
 Oregon..... State of..... I hereby certify that the within instrument was filed in this office  
 for record on the..... day of..... December..... 19 80  
 David Krumborn..... by Betty Shatto  
 (COUNTY OFFICIAL)..... (DEPUTY)