

Index File No. R-23

**CORNER RECORD (SEARCH)**

(Ref. FSM 7151.4)

Tract or Survey No. \_\_\_\_\_ Cor. No. \_\_\_\_\_

T 3 S. R. 32 E.

R.D. Ukiah County Umatilla

Merid. Will.

N.F. Umatilla State ORE.

**CORNER DIAGRAM**

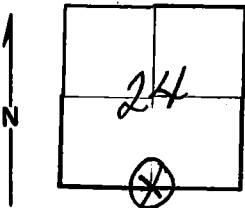

**DESCRIBE CORNER MONUMENT FOUND**

Stone 15" x 8" x 15" lying on surface, marked 1/4.

**DESCRIBE BEARING TREES OR OTHER OFFICIAL ACCESSORIES FOUND**

20" DBH. Pond. pine brs. S. 18° E. 156 lks.

Also found metal Bt. posters.

**PHOTO IDENTIFICATION DATA**

Photo No. \_\_\_\_\_  
 Filed At. \_\_\_\_\_  
 Object Ident. \_\_\_\_\_  
 Ident. By \_\_\_\_\_

*Signature*

**PLANE COORDINATE POSITION DATA**

State \_\_\_\_\_ Zone \_\_\_\_\_  
 X \_\_\_\_\_  
 Y \_\_\_\_\_  
 Estab. By \_\_\_\_\_

*Agency*

*Signature*

Melvin Christian

*Title*

*Division*

*Headquarters*

Ukiah

*Date*

6-19-73

7100-52-(3/68)

CORNER RECORD (PERPETUATION)

MONUMENT : DESCRIBE NEW MONUMENT SET, OR WORK DONE TO PRESERVE EXISTING MONUMENT

9

ACCESSORIES : DESCRIBE NEW BT's WITNESS OBJECTS ETC. ESTABLISHED, OR WORK DONE TO PRESERVE EXISTING EVIDENCE

10

Work Done By \_\_\_\_\_ Title \_\_\_\_\_ Date \_\_\_\_\_ State Registration No. or Agency \_\_\_\_\_

Certified Cor. Record Prepared ? Yes No Filed At: \_\_\_\_\_ Date \_\_\_\_\_ 11

REMARKS

12

Index File No. *R-23* T. R. M. Tract or Surv. No. Cor. 13