

USDA-FOREST SERVICE

Index
File No. N-9
T 3S R. 32E
Merid. Willamette

CORNER RECORD (SEARCH)

(Ref. FSM 7151.4)

R.D. Ukiah County Umatilla
N.F. Umatilla State Oregon
Tract or Survey No. Sec 20 Cor. No. NE

CORNER DIAGRAM

T3S R32E
S17 | S16
S20 | S21



DESCRIBE CORNER MONUMENT FOUND

17" x 11" x 4" basalt stone lying on surface of ground.

DESCRIBE BEARING TREES OR OTHER OFFICIAL ACCESSORIES FOUND

A 32" Fir Stump bears N15°E 21.78 ft dist (old BT, healed blaze).
A 18" Tamarack Stump bears S60°E 31.68 ft dist (old BT, visible scribing).

PHOTO IDENTIFICATION DATA

Photo No. 616140 780-8
Filed At. Umatilla Nat. Forest

Object Ident. Trees
Ident. By _____
Signature

PLANE COORDINATE POSITION DATA

State _____ Zone _____
X _____
Y _____
Estab. By _____
Agency

DESCRIBE CORNER LOCATION RELATIVE TO NEAR-BY FEATURES, ALSO HOW TO REACH CORNER

Yellow Jacket Road to road #5415, then East to road #030, then North to Bradley Spring, then 300 ft North to corner in timber 300 ft SW of cabin in clearing.

Signature

William R. Wells

Title

PLS 1106

Division

Headquarters

Date

September 27, 1982

7100-52-(3/68)

CORNER RECORD (PERPETUATION)

MONUMENT: DESCRIBE NEW MONUMENT SET, OR WORK DONE TO PRESERVE EXISTING MONUMENT

Set 2 1/2" brass cap on 2 1/2" x 30" l. pipe 24" in ground with mound of earth. Buried stone alongside monument.

Set steel fence post with 54-2 and 4 signs, West of corner. Cap marked:

T3S R32E
 S17 S16
 S20 S21
 1982
 PLS 1106

ACCESSORIES: DESCRIBE NEW BT'S WITNESS OBJECTS ETC. ESTABLISHED, OR WORK DONE TO PRESERVE EXISTING EVIDENCE

A 11" dia W. Fir bears S83°E 45.8 ft dist marked: T3S R32E S21 BT.

A 8" dia Red Fir bears N24°E 46.3 ft dist marked: T3S R32E S16 BT.

A 12" dia W. Fir Bears N65°W 62.3 ft dist marked: T3S R32E S17 BT.

A 9" dia Red Fir bears S46½°W 11.2 ft dist marked: T3S R32E S20 BT.

Blaze faces and 6" band around BTs, painted red, Trees tagged with 54-3 and 4 signs. Each new BT has lower blaze, scribed BT with brass washer stamped PLS 1106 nailed flush.

Work Done By W.R. Wells Title Surveyor Date 9/27/82 State Registration No. PLS 1106
 or Agency

Certified Cor. Record Prepared? Yes No Filed At Umatilla County Surveyor Office Date

REMARKS

Witnessed by: D.L. Kaufman PLS

Index File No. N-9 T. 3S R. 32E M. W.M. Tract or Surv. No. Sec 20 Cor. NE

Index
 File No. N-9
 T 3 S R. 32 E
 Merid. Willamette

CORNER RECORD (SEARCH)

(Ref. FSM 7151.4)

R.D. Ukiah County Umatilla State Oregon
 N.F. Umatilla State Oregon

Tract or Survey No. _____
 Cor. No. _____

N-9

CORNER DIAGRAM

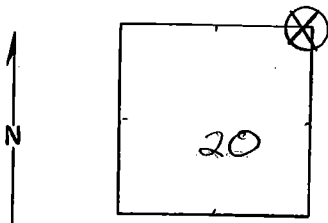

DESCRIBE CORNER MONUMENT FOUND

Material: None reliable
 Markings: A loose stone lies in approximate proper location according to B.T.'s but does not appear to be of proper dimensions.

DESCRIBE BEARING TREES OR OTHER OFFICIAL ACCESSORIES FOUND

A 16" western larch stump in SE quadrant has old B.T. tag and "Attention" poster. Burned out but appears to have been scribed on NW face. It has had red ring painted around it. A 36" fir in NE quadrant has old blaze on SW face and a red ring painted around it.

PHOTO IDENTIFICATION DATA

Photo No. _____
 Filed At. _____
 Object Ident. _____
 Ident. By _____
Signature

DESCRIBE CORNER LOCATION RELATIVE TO NEAR-BY FEATURES, ALSO HOW TO REACH CORNER

Fence runs west (it also runs southerly and then easterly to encompass spring. Definitely not on any line, except west) corner location is approximately 250 feet south of cabin.

PLANE COORDINATE POSITION DATA

State _____ Zone _____
 X _____
 Y _____
 Estob. By _____
Agency

Signature
Tom Hollamon

Title
Eng, Tech,

Division _____

Headquarters _____

Date
10/8/75

7100-52 (3/68)

CORNER RECORD (PERPETUATION)

MONUMENT: DESCRIBE NEW MONUMENT SET, OR WORK DONE TO PRESERVE EXISTING MONUMENT

ACCESSORIES : DESCRIBE NEW BT's WITNESS OBJECTS ETC. ESTABLISHED, OR WORK DONE TO PRESERVE EXISTING EVIDENCE

I put up no tags since I was not sure of B.T.'s.

Work Done By _____ Title _____ Date _____ State Registration No. _____
or Agency _____
Certified Cor. Record Prepared ? Yes No Filed At: _____ Date _____

REMARKS

Index File No. T. R. M. Tract or Surv. No. Cor. _____

N-9

Index File No. N-9 CORNER RECORD (SEARCH) (Ref. FSM 7151.4) Tract or Survey No. _____ Cor. No. _____
 T 3 S. R. 32 E. R.D. UKIAH County UMATILLA
 Merid. W. N.F. UMATILLA State ORE.

CORNER DIAGRAM

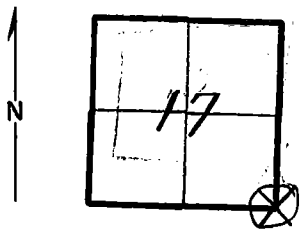

DESCRIBE CORNER MONUMENT FOUND

probable corner stone

DESCRIBE BEARING TREES OR OTHER OFFICIAL ACCESSORIES FOUND

1 BT. A broken of FIRE SNAG 20" DBS.
 N. 17° E. 33 lks., scribing is in poor
 condition Did not see this on 10/75. J&H.

PHOTO IDENTIFICATION DATA

Photo No. _____
 Filed At. _____
 Object Ident. _____
 Ident. By _____
 Signature _____

DESCRIBE CORNER LOCATION RELATIVE TO NEAR-BY FEATURES, ALSO HOW TO REACH CORNER

Follow Road S-811-A to Fence, then by COMPASS
 course APPROX. 4 chains,
 West ?

PLANE COORDINATE POSITION DATA

State _____ Zone _____
 X _____
 Y _____
 Estab. By _____
 Agency _____

Signature Don McCullough Title For. Tech. Division _____ Headquarters UKIAH Date 7-68 7100-52 (3/68)

CORNER RECORD (PERPETUATION)

MONUMENT: DESCRIBE NEW MONUMENT SET, OR WORK DONE TO PRESERVE EXISTING MONUMENT

ACCESSORIES : DESCRIBE NEW BT'S WITNESS OBJECTS ETC. ESTABLISHED, OR WORK DONE TO PRESERVE EXISTING EVIDENCE

Work Done By _____ Title _____ Date _____ State Registration No. or Agency _____

Certified Cor. Record Prepared ? Yes No Filed At: _____ Date _____

REMARKS

Index File No. N-9 T. R. M. Tract or Surv. No. Cor. _____

Index File No. N-9

CORNER RECORD (SEARCH)

(Ref. FSM 7151.4)

Tract or Survey No. _____

Cor. No. _____

N-9

T 3 S. R. 32 E.

R.D. UKIAH

County UMATILLA

Merid. W.

N.F. UMATILLA

State ORE.

CORNER DIAGRAM

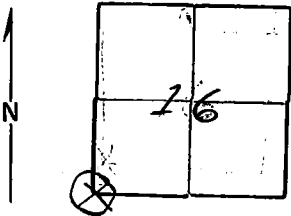

DESCRIBE CORNER MONUMENT FOUND

Basalt stone 18"x10"x5", 5" Above ground with 2 notches - good shape

DESCRIBE BEARING TREES OR OTHER OFFICIAL ACCESSORIES FOUND

32" O.B.H. Doug. Fir brs. N. 17° E. 33 lks. Fair condition.
Western Larch stump brs. S. 62° E. 48 lks.

PHOTO IDENTIFICATION DATA

Photo No. _____

Filed At. _____

Object Ident. _____

Ident. By _____

Signature

PLANE COORDINATE POSITION DATA

State _____ Zone _____

X _____

Y _____

Estab. By _____

Agency

Signature

D. McCullough

Title

Forestry Tech.

Division

Headquarters

UKIAH

Date

6-28-67

7100-52 (3/68)

CORNER RECORD (PERPETUATION)

11

MONUMENT : DESCRIBE NEW MONUMENT SET, OR WORK DONE TO PRESERVE EXISTING MONUMENT

9

ACCESSORIES : DESCRIBE NEW BT's WITNESS OBJECTS ETC. ESTABLISHED, OR WORK DONE TO PRESERVE EXISTING EVIDENCE

10

Work Done By _____ Title _____ Date _____ State Registration No. or Agency _____

Certified Cor. Record Prepared ? Yes No Filed At: _____ Date _____

REMARKS

12

Index File No. N-9 T. R. M. Tract or Surv. No. Cor. 13