

# RECORD OF LAND CORNER MONUMENTATION

NORTH 1/4 CORNER SECTION 21, T. 3 S., R. 32 E., W.M.

17	16	●	16	15
20	21		21	22
20	21		21	22
29	28		28	27

**ORIGINALLY ESTABLISHED BY:** George S. Pershin, U.S. Deputy Surveyor

**CONTRACT NUMBER:** 430

**CONTRACT DATE:** March 23, 1882

**ORIGINAL DESCRIPTION:** Set a basalt stone 12 x 8 x 7 ins 8 ins in ground on small flat for 1/4 Sec. cor. marked 1/4 on N. face.

A Pine 4 ins. di. brs. N.48°W. 18 lks dist marked 1/4 S. B.T.

A Pine 16 ins. di. brs. S.30°E. 53 lks dist marked 1/4S. B.T.

**EVIDENCE FOUND:** Found a stone 12"x8"x7" clearly marked 1/4, lying with the marked face down with no other stones. From which, I also found the remains of the original southeast bearing tree, which is a dead and down (windthrown) ponderosa pine, with blaze and partial scribing "4S" visible. The center of the rootwad hole bears S.26°E., 35 ft. I searched for but found no remains of the other bearing tree. I accept the position of the marked stone for the corner.

**DESCRIPTION OF MONUMENTS AND ACCESSORIES SET AND METHODS USED:**

At the corner point, I set a standard USFS 2½"x30" aluminum pipe with attached ¾" aluminum cap 24" in the ground. Built a 2 ft. diameter mound of stone around the monument to top of cap. Cap is marked as shown below.

**From which, I SCRIBE NEW BEARING TREES:**

- ▶ A western larch, 10" dbh bears N.37°E., 7.77 ft. marked 1/4 S16 in upper blaze and BT in lower blaze
- ▶ A white fir, 6" dbh bears S.77°E., 14.24 ft. marked X in upper blaze and BT in lower blaze
- ▶ A western larch, 6.5" dbh bears S.62°W., 11.43 ft. marked X in upper blaze and BT in lower blaze
- ▶ A Douglas-fir, 9" dbh bears N.82°W., 28.45 ft. marked 1/4 S16 in upper blaze and BT in lower blaze

CORNER MONUMENT  
MARKED:

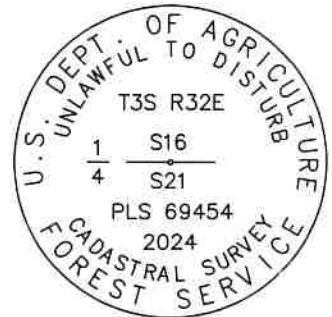

Deposit marked corner stone inverted, south, and alongside the pipe. Placed a blue plastic-encased magnet at base of pipe. Painted a 6 inch red band around each bearing tree, and also painted blazes red and attached USFS 54-3 and 54-9 signs. Used RTK GPS to measure bearings. Distances to bearing trees measured with a steel tape, measuring to a Mag Spike driven in the side-center-right at the root crown of each tree, with an attached ½" aluminum washer stamped PLS 69454. Bearings are geodetic, derived by GPS observation at the corner. Set an aluminum guard post west, 5 ft., with USFS signs 52-4 and 52-9 attached, and another guard post east, 5 ft., with USFS sign 54-2 attached. Corner is located approximately 14 ft. north of an east-west running fence line.

**RESTORATION BY, STAMP AND DATE:**

Work completed June 24, 2024 by:

Jason L. Hatfield, PLS  
Vince L. Kelly, Survey Technician  
Spencer B. Jones, Survey Technician

USDA FOREST SERVICE  
NORTHEAST OREGON LAND ZONE  
1550 Dewey Avenue, Suite A  
Baker City, OR 97814  
(541) 523-1283



EXPIRES: 6/30/2025

24-078-β