

CERTIFIED RECORD OF LAND CORNER MONUMENTATION

---

History of original corner establishment:

Index: R-23

Quarter corner between sections 24 and 25  
 T3S R31E Wilamette Meridian  
 Original corner was set by George S. Pershin under  
 Contract Number 319 in 1879.  
 His record reads:  
 Set Pine Post for 1/4 section corner  
 from which  
 A Tamarach 10" ins. diam. bears S 32°E, 16 lks. dist.  
 A Fir 7" ins. diam. bears North, 17 lks. dist.

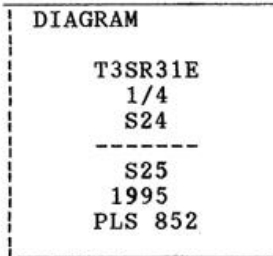

Description of corner evidence found:

Found the broken off portion of a fir snag with fence wire on it and the scribing plainly visible lying on the ground northwest of the corner. A fir stump with the mirror image of the scribing in the wood which grew over the blaze was still standing in its original position. A Tamarach with a healed blaze was also found. No evidence of the pine post was found.

Description of monument and accessories I established to perpetuate the original location of this corner:

The bearings were based on the record bearings of the original witness trees.

I set a 2 1/2 inch brass disk on a 30" galvanized iron pipe 28" below the surface of the ground at the record distances from the existing bearing objects. A circle of stone was placed around the monument and the monument marked as in the diagram above.

I set the following new witness trees:

A 19.6" dbh Western Larch bears N69°23'W, 40.9' scribed 1/4 S24BT.  
 A 9.6" dbh Lodge Pole Pine bears N62°06'E, 84.5' scribed 1/4S24BT.  
 A 7" dbh lodge pole Pine bears S5°21'E, 88.2' scribed 1/4S25BT.  
 An Brass washer stamped ORLS 852 and WALS 13922 is nailed between the letters B and T on the new trees. All the BT's have BT signs attached. Painted 2, 1" red bands around all the trees and painted the scribe blazes red. Placed a 6' steel post by the mound with a Umatilla County Land Survey Monument sign on it.  
 This work was done October 17, 1995 and witnessed by Stephen K. Haddock.

Office of Survey Dept. County of Umatilla  
 State of Oregon, I hereby certify that the within instrument was filed  
 in this office for record on the 23<sup>rd</sup> day of October, 1995.

( COUNTY OFFICIAL )

by ( DEPUTY )

Form R6-7100-57 (9/71)

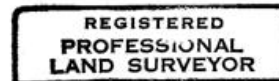

*David L. Haddock*



RECEIVED BY  
 Umatilla County Surveyor  
 Date 10-95  
 Rec'd By KK  
 No. 95-183-R