

U. S. DEPARTMENT OF AGRICULTURE
FOREST SERVICE

Umatilla NATIONAL FOREST

CORNERS OF THE PUBLIC SURVEY

T. 37 R. 38E W Mer.

Section Corner common to Sections
27, 28, 33, and 34

Corner consists of a W. 2. Diameter 14" Dia (not) in place
State condition Poor - Well not stand much longer

Dimensions above ground diag 24 feet inches.
Sketch grooves, letters, figures, or notches, on proper face or edge.

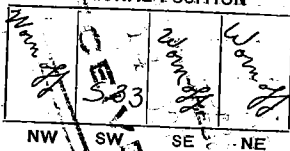
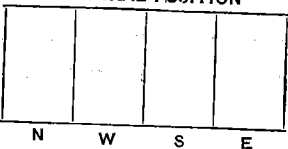

Mound of _____ is located _____

Pits are located _____

Sketch markings of Bearing Trees (or Rocks) in proper box and fill blanks below, giving bearings from Corner to Trees and Distances in Links.

| | | | |
|----------------|--|--|--|
| <u>Quercus</u> | | | |
| | | | |

Species W. 2.
 Diameter 18"
 Bearing N 7 W
 Distance 13.5 ft

Do you believe this to be a genuine Land Office Corner? Yes
If not, why? _____

F. A. Monroe
Signature

8-11-31
Date

J. J.
Title

T. 37 R. 38 W. Mer.

8-3027

(Make sketch of topography near Corner.)

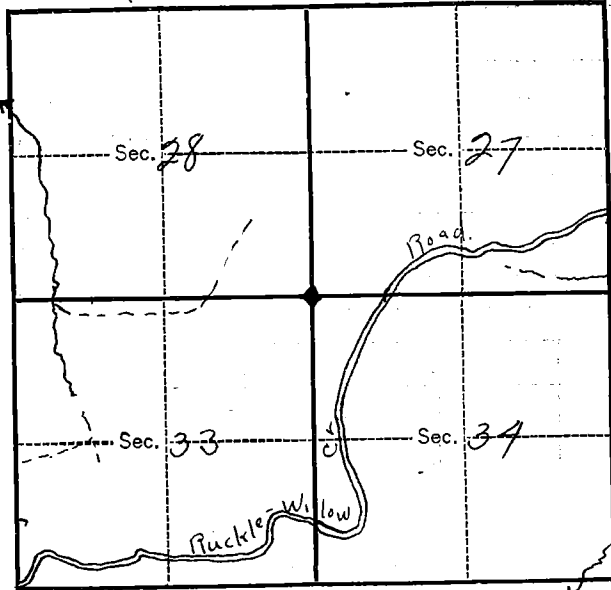

Metal Location Poster is on a W 7'
 tree 18 inches diameter, on the NE
 side of tree
 from which this Corner bears S 7 E
17 link chains distant.

Give any further facts which will aid in finding this
 Corner again.

Corner is a squared up
W 7' and all faces worn
off except SW corner of 33.
Corner is 21 chain west
of road in W 7' reprod
slope gentle west. A section
line sign board and metal
cruiser tag have been placed
of west side of road due east
of corner