

USDA-FOREST SERVICE

Index
File No. J-9
T 3N R. 38E
Merid. WILLAMETTE

CORNER RECORD (SEARCH)

(Ref. FSM 7151.4)

R.D. WALLA WALLA County UMATILLA
N.F. UMATILLA State OREGON

Tract or
Survey No. _____
Cor.
No. _____

CORNER DIAGRAM

T3N R38E

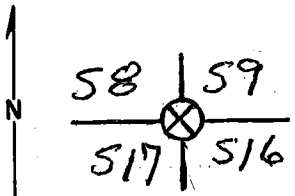

DESCRIBE CORNER MONUMENT FOUND

PIECE OF ROCK LEDGE PROJECTING UP
24" AS DESCRIBED IN NOTES, PART OF TOP
HAS BROKEN OFF & NO MARKS REMAIN.
TOP OF ROCK IS CRACKED & IS LOOSE.

DESCRIBE BEARING TREES OR OTHER OFFICIAL ACCESSORIES FOUND

ORIG. 6" FIR IS A 14" DOUG-FIR WITH DOUBLE
HEALED BLAZES, HAS A DEAD TOP & BUSHY, LIVE
LOWER LIMBS. BEARS N40°E, 14.52 FEET.
ORIG. 22" FIR IS A 34" PONDEROSA PINE WITH
A LARGE HEALED BLAZE. BEARS N21°W, 14.52 ft.

PHOTO IDENTIFICATION DATA

Photo No. _____
Filed At. _____
Object Ident. _____
Ident. By _____

Signature

PLANE COORDINATE POSITION DATA

State _____ Zone _____
X _____
Y _____
Estab. By _____

Agency

DESCRIBE CORNER LOCATION RELATIVE TO NEAR-BY FEATURES, ALSO HOW TO REACH CORNER

CORNER IS ABOUT 100 FEET NORTH OF
A SMALL E-W DRAW ON A ROCKY POINT.
WOODWARD CREEK IS ABOUT 200 FEET
WEST. THE 1901 CORNER, RECORD NORTH,
300 FEET, IS ON A ROCKY POINT IN OPENING,
JUST AS DESCRIBED IN 1901 NOTES. (SEE BACK)

Signature

Title

Division

Headquarters

Date

FS-7100-52 (3/68)

Dennis L. Laylord PLS 1636 SEPT 30, 1997

CORNER RECORD (PERPETUATION)

MONUMENT: DESCRIBE NEW MONUMENT SET, OR WORK DONE TO PRESERVE EXISTING MONUMENT.

NONE - NEEDS A ROCK CAP

ACCESSORIES : DESCRIBE NEW BT'S WITNESS OBJECTS ETC. ESTABLISHED, OR WORK DONE TO PRESERVE EXISTING EVIDENCE

I PLACED BT SIGNS ON THE 2 BT'S AT THE 1903 CORNER AND ALSO ON THE 3 BT SNAGS AT THE 1899 CORNER.

(CONTINUED FROM BELOW):

WITH HEALED BLAZES. BEARS N72°W, 81 LKS. 15 WEST OF CREEK.

Work Done By _____ Title _____ Date _____ State Registration No. or Agency _____

Certified Cor. Record Prepared? Yes No Filed At: _____ Date _____

REMARKS

I COULD FIND NO MARKS FOR THE 1901 CORNER ON THE ROCK LEDGE. AT THE 1899 CORNER, N54°W, 158.4 FEET FROM THE 1901 CORNER, I FOUND? CORNER IS IN ROCK SLIDE, FROM WHICH: BROKEN 36" FIR SNAG W/ HEALED BLAZE BEARS N23°45'E, 105 LKS. ORIG. 6" FIR IS NOW A 24" FIR SNAG WITH LARGE HEALED BLAZE, BEARS S1°W, 53 LINKS. ORIG. 20" BALM IS NOW A 24" X 20' HIGH SNAG, (COTTONWOOD)

Index File No. J-9 T. T3N R. R38E M. WILL Tract or Surv. No. Cor. 13