

CERTIFIED RECORD OF LAND CORNER MONUMENTATION

History of original corner establishment:

Corner originally established by George S. Pershin under GLO contract number 304, dated September 19, 1878. Surveyor General record states:

Set fir post on South hillside for 1/4 sec cor
 Fir 4 in diam brs N55°W, 19 lks dist
 Fir 12 in diam brs S62°E, 72 lks dist

Corner found by William E. Campbell under GLO contract number 718, dated May 1, 1900. Surveyor General record states:

In retracing the S Bdy of sec 35, I discover it to be defective.
 Set basalt stone 15x10x4 ins 10 ins in the ground for 1/4 sec cor
 S Bdy sec 35 marked 1/4 on N face from which;
 A fir 18 ins diam bears N20°E, 96 lks dist marked 1/4 S35 BT
 The old 1/4 sec cor-post missing-bears N75°W, 1 ch 10 lks dist as determined by witness tree,
 a fir 12 ins diam marked and witnessed as described by the Surveyor General.
 I destroy all traces of this old 1/4 sec cor.

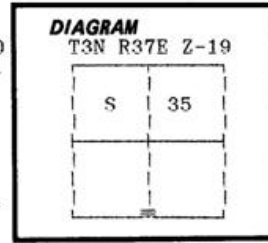

No record of subsequent monumentation found in Umatilla County survey records.

Description of corner evidence found:

Found no evidence of the original corner monument

Found a 24 inch diameter Douglas Fir N20°E,
 96 lks. Tree is live and vigorous with blaze evident.

Description of monument and accessories I established to perpetuate the

original location of this corner: At record bearing and distance from the found original bearing tree, I set a 2 1/2" x 30" aluminum pipe with aluminum cap marked as shown, 26 inches in the ground, from which:

New Bearing Trees and Bearing Object;
 A 5/8"x30" iron pin with plastic cap marked BGA SURVEY MARKER bears S29°E, 6.35 feet
 A 16 inch diameter Douglas Fir bears N88°W, 42.51 feet marked X BT
 A 19 inch diameter Douglas Fir bears N14°W, 36.71 feet marked 1/4 S35 BT

Attached Bearing Tree and Land Survey Monument signs to the bearing trees.

Set a steel fencepost approximately 5 feet North with Land Survey Monument sign attached.

I hereby certify that the above corner point was perpetuated as hereon described on June 28, 1991.

Witnesses: Jeff Petersen and Jeff Bennett

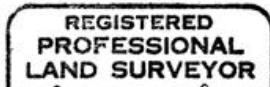

Duane I. Griffith
 OREGON
 JULY 10, 1964
DUANE I. GRIFFITH
 644

I used a steel tape and magnetic compass in the establishment of new accessories. I used 20° East magnetic declination and the distances are to a 50d spike driven in the right side of the root crown. I attached a brass washer marked OPLS 644 to the BT blaze.

Office of..... County of.....
 State of....., I hereby certify that the within instrument was filed in this office for record on the..... day of....., 19.....
 by
 (COUNTY OFFICIAL) (DEPUTY)

Form R6-7100-57 (9/71)

RECEIVED BY
 Umatilla County Surveyor Z-19
 Date 10-92
 Rec'd By KK
 No. 92-118-R