

CERTIFIED RECORD OF LAND CORNER MONUMENTATION

**History of original corner establishment:**

Corner originally established by William E. Campbell under GLO contract number 718, dated May 1, 1900. Surveyor General record states:

Set an ironstone 20x10x4 ins, 15 ins in the ground for 1/4 sec cor from which;

A Pine 6 ins diam bears S10°E, 1 ch 73 lks dist marked 1/4 S36 BT  
 A Fir 9 ins diam bears N45°W, 78 lks dist marked 1/4 S35 BT

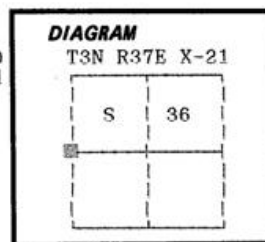

No record of subsequent monumentation found in Umatilla County survey records.

**Description of corner evidence found:**

Found no evidence of the original corner monument.

Found a 28 inch diameter Ponderosa Pine S10°E, 173 lks live and vigorous with blaze evident.

Found a 25 inch diameter Douglas Fir N45°W, 78 lks live and vigorous with blaze evident.

**Description of monument and accessories I established to perpetuate the**

**original location of this corner:** At record bearing and distance from the found original bearing trees, I set a 2 1/2" x 30" aluminum pipe with aluminum cap marked as shown, 24 inches in the ground, from which:

**New Bearing Objects:**

A 5/8"x30" iron pin with plastic cap marked BGA SURVEY MARKER bears East, 3.35 feet  
 A 5/8"x30" iron pin with plastic cap marked BGA SURVEY MARKER bears South, 3.65 feet

Attached Bearing Tree and Land Survey Monument signs to the bearing trees.

Set a steel fencepost approximately 5 feet East with Land Survey Monument and Wilderness Boundary signs attached.

I hereby certify that the above corner point was perpetuated as hereon described on August 1, 1991.

Witnesses: Jeff Petersen and Jim Bennett

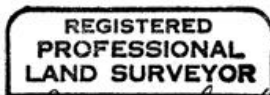

*Handwritten signature of Duane I. Griffith*

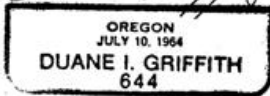

I used a steel tape and magnetic compass in the establishment of new accessories. I used 20° East magnetic declination and the distances are to a 50d spike driven in the right side of the root crown. I attached a brass washer marked OPLS 644 to the BT blaze.

Office of..... County of.....  
 State of....., I hereby certify that the within instrument was filed in this office for record on the..... day of....., 19.....  
 ..... by .....  
 (COUNTY OFFICIAL) (DEPUTY)

Form R6-7100-57 (9/71)

RECEIVED BY  
 Umatilla County Surveyor  
 Date 10-92 X-21  
 Rec'd By RC  
 No. 92-118-R