

Form 874-9—Revised May, 1918
 U. S. Department of Agriculture
 FOREST SERVICE

Umatilla NATIONAL FOREST

CORNERS OF THE PUBLIC SURVEY

T. 3 N R. 37 E W Mer.

Sec. Corner common to Sections
21, 22, 27 and 28

Corner consists of a pile of rocks (not) in place
 State condition Poor

Dimensions above ground _____ inches.
 Sketch grooves, letters, figures, or notches, on proper face or edge.

CARDINAL POSITION

DIAGONAL POSITION

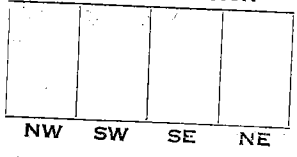
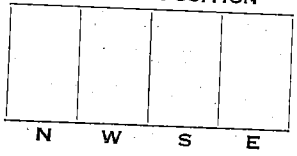

Mound of _____ is located _____

Pits are located _____

Sketch markings of Bearing Trees (or Rocks) in proper box and fill blanks below, giving bearings from Corner to Trees and Distances in Links.

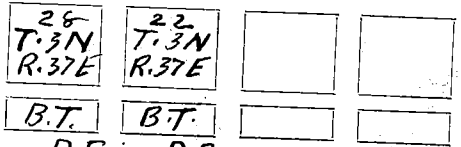

Species D.F. D.F.
 Diameter 14" 22"
 Bearing S. 42° W N. 64° E
 Distance 28' 18'

Do you believe this to be a genuine Land Office Corner? YES.
 If not, why? _____

Albert Baker
 (Signature)

Miss. Ranger.
 (Title)

11-23-38
 (Date)

T. 3N. R. 37E W Mer.

(Make sketch of topography near Corner)

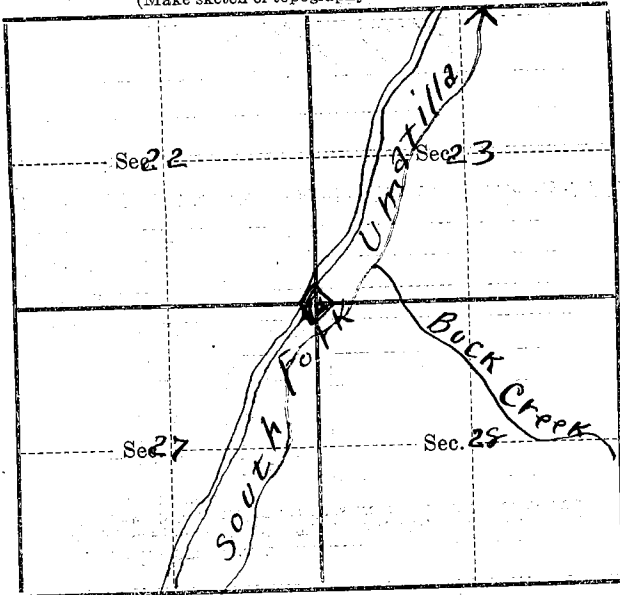

Metal Location Poster is on a *Ponderosa Pine* tree 8 inches diameter, on the W side of road from which this Corner bears S. 20 E 1 1/4 chains distant.

Give any further facts which will aid in finding this Corner again.

Corner is in center of road right of way 1/4 mile S. of Buck Creek. One witness tree cut by C.C. road slashing crew and the only other witness tree is a dead one 20 ft. below road on hill side.

PENDLETON, OREGON

NOV 25 1938

RECEIVED

Form 874-9—Revised May, 1918
 U. S. Department of Agriculture
 FOREST SERVICE

Winnatillan NATIONAL FOREST

CORNERS OF THE PUBLIC SURVEY

T. 3N R. 37 E. W Mer.

Sections Corner common to Sections
21, 22, 27, and 28

Corner consists of a Stone ~~(not)~~ in place
 State condition Good

Dimensions above ground 4" x 5" x 15" inches
 Sketch grooves, letters, figures, or notches, on proper face or edge.

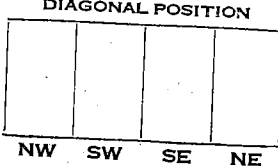
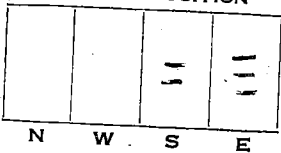

Mound of _____ is located _____

Pits are located _____

Sketch markings of Bearing Trees (or Rocks) in proper box and fill blanks below, giving bearings from Corner to Trees and Distances in Links.

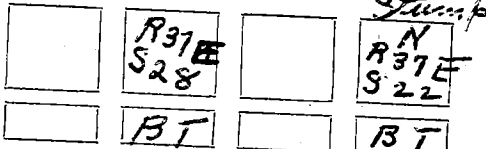

Species DF YP
 Diameter 14 in 25"
 Bearing S52°30'W N53°E
 Distance 74 ft 6 in 42 ft 2 in

Do you believe this to be a genuine Land Office Corner? Yes
 If not, why? _____

H. J. Lusk
 (Signature)
Aug 13/47 Dist Ranger
 (Date) (Title)

T. _____ R. _____ Mer. _____

(Make sketch of topography near Corner)

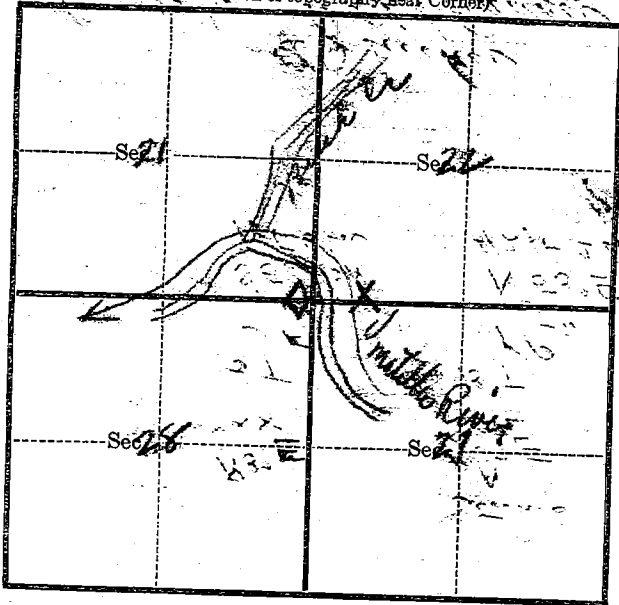

Metal Location Poster is on a WF
tree _____ inches diameter, on the South
side of Road + Umattilla River
from which this Corner bears North
149 ft 10 in distant.

Give any further facts which will aid in finding this
Corner again.

About 1/4 mi above mouth of
Rock Creek in Umattilla River
Road River is above rock around
sharp point. Converse tag placed
across River from corner to road
because of narrow rock cut.
Large log chopped in tree near
converse tag.

USDA-FOREST SERVICE

Index
File No. R-13

CORNER RECORD (SEARCH)

(Ref. FSM 7151.4)

Tract or
Survey No. _____

Cor.
No. _____

T. 3N R. 37E R.D. WALLA WALLA County UMATILLA

Merid. WILLAMETTE N.F. UMATILLA State OREGON

CORNER DIAGRAM

T3N R37E

DESCRIBE CORNER MONUMENT FOUND

NONE - PROBABLY SLID DOWN HILL INTO ROAD.

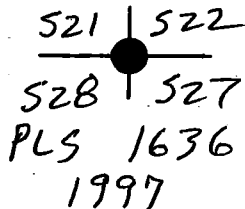

DESCRIBE BEARING TREES OR OTHER OFFICIAL ACCESSORIES FOUND

PINE ROOT CROWN N57°E, 418 ft. NO MARKS.
FIR ROOT CROWN S19°E, 1254 ft. NO MARKS.
THIS TREE WAS EAST OF UMATILLA RIVER.
FIR ROOT CROWN WITH FRAG, SCRIBES DOWN SLOPE.
BEARS S45°W, 5,28 ft.
DRIG. 36" PINE IS DOWN, IMPEN TO SCRIBES.

PHOTO IDENTIFICATION DATA

Photo No. _____
Filed At. _____
Object Ident. _____
Ident. By _____

Signature

DESCRIBE CORNER LOCATION RELATIVE TO NEAR-BY FEATURES, ALSO HOW TO REACH CORNER
ROOT HOLE BEARS N60 1/2° W, 65,34 ft.

PLANE COORDINATE POSITION DATA

State _____ Zone _____
X _____
Y _____
Estab. By _____ Agency _____

CORNER IS ABOVE TOP OF ROCK CUT ABOUT 20 FEET. (ROAD # 32).

Signature

Title

Division

Headquarters

Date

FS-7100-52 (3/68)

Dennis J. Daylond PLS 1636 10/9/1997

CORNER RECORD (PERPETUATION)

MONUMENT: DESCRIBE NEW MONUMENT SET, OR WORK DONE TO PRESERVE EXISTING MONUMENT

SET 2 1/2" ALUM. PIPE W/ 3 1/4" ALUM. CAP 30"
IN GRND. CAP IS MARKED AS IN DIAGRAM &
IS FLUSH WITH GROUND.

ACCESSORIES : DESCRIBE NEW BT's WITNESS OBJECTS ETC. ESTABLISHED, OR WORK DONE TO PRESERVE EXISTING EVIDENCE

16" POND. PINE BRS N 38° 30' E, 78 1/4 FEET
5/8" x 24" IRON ROD ON ROCK POINT BEARS S 85° 30' E, 26.5 ft
5/8" x 24" IRON ROD ON ROCK POINT W/ 1 1/2" ALUM. CAP
BEARS S 68° 15' W, 49 1/2 FEET.
22" DOUG-FIR BEARS N 27° 30' W, 78 1/4 FEET.

Work Done By D. GAYLORD Title FOREST L.S. Date 10/9/97 State Registration No. 1636
or Agency

Certified Cor. Record Prepared? Yes No Filed At: UMATILLA COUNTY SURVEYOR Date 10/10/97

REMARKS

Index File No. R-13 T. T3N R. R37E M. WILL. Tract or Surv. No. Cor. 13