

U. S. DEPARTMENT OF AGRICULTURE  
FOREST SERVICE

Umatilla NATIONAL FOREST

CORNERS OF THE PUBLIC SURVEY

T. 3N R. 37E W. \_\_\_\_\_ Mer.

1/4 Section 17 Corner common to Sections  
4, 5, and \_\_\_\_\_

DESCRIPTION OF CORNER

Corner consists of a Stake in top corner  
4" x 4" x 20" inches.

Dimension above ground \_\_\_\_\_ inches.  
Sketch grooves, letters, figures, or notches, on proper face or edge.

CARDINAL POSITION

DIAGONAL POSITION

<u>Illegible on account of decay.</u>				<u>Illegible on account of decay.</u>			
N	W	S	E	NW	SW	SE	NE

Mound of \_\_\_\_\_ is located \_\_\_\_\_

Pits are located \_\_\_\_\_

Sketch markings of Bearing Trees (or Rocks) in proper box and fill blanks below, giving bearings from Corner to Trees and Distances in Links.

<u>1/4 S.</u> <u>S. 35</u> <u>T. 3N</u> <u>R. 37E</u>	<u>1/4 S.</u> <u>S. 4</u> <u>T. 3N.</u> <u>R. 37E</u>		
<u>BT</u>	<u>BT</u>		

Species Lch. Lch. \_\_\_\_\_  
 Diameter 20" 18" \_\_\_\_\_  
 Bearing N33°E N31W \_\_\_\_\_  
 Distance 21' 18' \_\_\_\_\_

Do you believe this to be a genuine Land Office Corner? Yes

If not, why? \_\_\_\_\_

Albert Baker

Signature.

May 4 1928  
Date.

Forest Ranger  
Title.

T. 3N R. 37E W. Mer.

8-3027

(Make sketch of topography near Corner.)

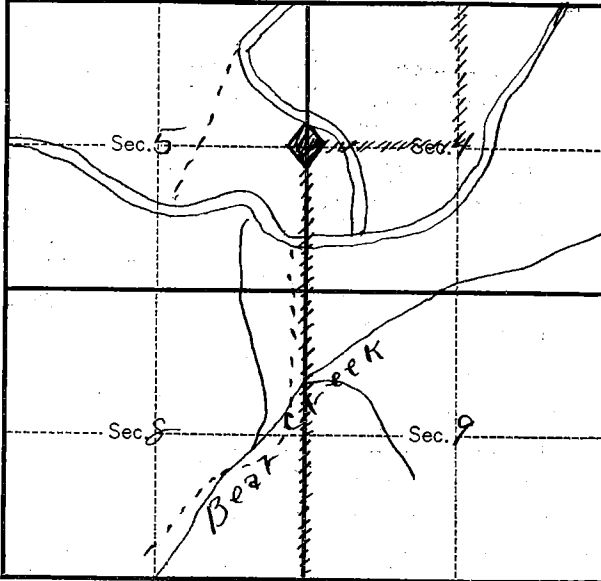

Metal Location Poster is on a Dead Larch  
tree 26 inches diameter, on the East  
side of tree  
from which this Corner bears N.E.  
13' ~~chains~~ distant.

Give any further facts which will aid in finding this  
Corner again.

An an old logging road  
at north end of Ferguson  
pasture fence.  
Corner not difficult to find

LAND CORNER RECORD

LL 5680.2

1. T 3N R 37E No. c 9 Cor. 1/4 Mer. Will State Oregon (Rectangular) N. F. Umatilla Dist. Pendleton **8**

2. Corner Status

3. Original Description Resurvey Vol. 192 Page 28 Where Recorded GLO year 1879

4. Description of Corners: Resurvey set willow post on level plateau for 1/4 section corner.  
 Tamarack 16" di. brs. N 34° E 29 lks.  
 Tamarack 15" di. brs. N 26° W 26 lks.  
 Theodore Roman's house brs. S 55° W 250 lks.

5. Investigation Notes: Found a 24" fir with K tag stating approx. 1/4 cor. of sec. 5 & 4. Scribing on tag is: Sec. 5 T3N, R37E App. 1/4 cor. L.D.B. 9-4-57 M.R.S. 4-10-61.

No B.Ts. found. The 24" fir is used as a corner post for fence line that runs N & S then turns W. Small stream runs E & W from fir. At approx 50' N the fence crosses main logging road. Gate across road. Area has been logged.

7. Photo Identification  
 Photo No. UM 32B-5  
 Ident. By: \_\_\_\_\_

8. Plane Coordinate Position Data  
 State \_\_\_\_\_ Zone \_\_\_\_\_  
 X \_\_\_\_\_  
 Y \_\_\_\_\_  
 Estab. By \_\_\_\_\_  
 Field Book No. \_\_\_\_\_  
 Where Filed \_\_\_\_\_

9. Evaluation  
 Authentic \_\_\_\_\_  
 Needs Verif.  Monument NO  
 Re-estab.  Survey \_\_\_\_\_  
 Land Status \_\_\_\_\_

I tied orange ribbon and sprayed silver paint on 24" fir.

Use old logging road for route into area shown on photo.

6. Signed A. Galbraith Title Range. Tech. Date 5-12-64

PERPETUATION RECORD

10. Monument:

11. Accessories

Field Book \_\_\_\_\_ Page \_\_\_\_\_

12. Set By \_\_\_\_\_ Title \_\_\_\_\_

License \_\_\_\_\_ Agency \_\_\_\_\_ Date \_\_\_\_\_

13. Recorded By \_\_\_\_\_ Volume \_\_\_\_\_ Page \_\_\_\_\_  
(Agency)

(Date) (City) (County) (State)

14. Remarks: