

Form 874-9—Revised May, 1918  
**U. S. DEPARTMENT OF AGRICULTURE**  
**FOREST SERVICE**

Umatilla NATIONAL FOREST

**CORNERS OF THE PUBLIC SURVEY**

T. 34 N R. 37 E W. Mer.

Sec. Corner common to Sections  
2, 3, 34, and 35

Corner consists of a Yew wood stake in place  
 State condition good

Dimensions above ground 6 inches.  
 Sketch grooves, letters, figures, or notches, on proper face or edge.

CARDINAL POSITION				DIAGONAL POSITION			
				S	S	S	S
				34	3	2	35
N	W	S	E	NW	SW	SE	NE

Mound of \_\_\_\_\_ is located \_\_\_\_\_

Pits are located \_\_\_\_\_

Sketch markings of Bearing Trees (or Rocks) in proper box and fill blanks below, giving bearings from Corner to Trees and Distances in Links.

S-34 T. 4 N R. 37 E	S-3 T. 3 N R. 37 E	S-2 T. 3 N R. 37 E	
BT	BT	BT	

Species W.F. W.F. W.F. (Dead)  
 Diameter 28" 30" 22"  
 Bearing N-31 W. S-55 W. S-53 E  
 Distance 26' 16' 18'

Do you believe this to be a genuine Land Office Corner? Yes

If not, why? \_\_\_\_\_  
 \_\_\_\_\_  
 \_\_\_\_\_

Albert Baker  
 Signature.

5-23-30  
 Date.

Forest Ranger  
 Title

T. 11 N. R. 37 E. W. Mer.

8-3027

(Make sketch of topography near Corner.)

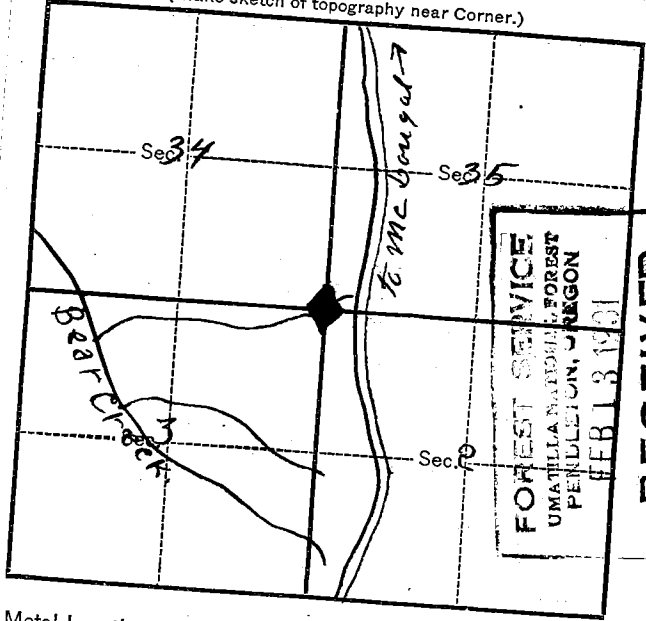

Metal Location Poster is on a W.F.  
 tree 10 inches diameter, on the S  
 side of Corner  
 from which this Corner bears N. 10° W.  
1/3 chains distant.

Give any further facts which will aid in finding this Corner again.

Corner is in bottom of a small  
canyon which is a branch of  
Bear Creek. Slope 30%, medium  
stand of timber, both mature and  
reprod. Open bunchgrass ridge  
5 ch. south.



T3-4 N. R. 37 E. W. Mer.

8-3027

(Make sketch of topography near Corner.)

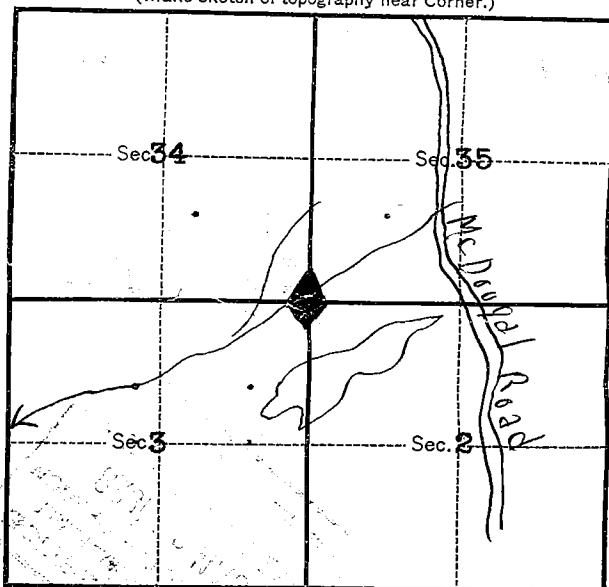

Metal Location Poster is on a \_\_\_\_\_  
tree \_\_\_\_\_ inches diameter, on the \_\_\_\_\_  
side of \_\_\_\_\_  
from which this Corner bears \_\_\_\_\_  
\_\_\_\_\_ chains distant.

Give any further facts which will aid in finding this  
Corner again.

Large opening 5 chains south of  
corner. Corner in bottom of small  
draw leading into Bear Creek.

USDA-FOREST SERVICE

Index  
File No. A-17

CORNER RECORD (SEARCH)

(Ref. FSM 7151.4)

Tract or Survey No. \_\_\_\_\_ Cor. No. \_\_\_\_\_

T 3N R. 37E

R.D. WALLA WALLA County UMATILLA

Merid. Will

N.F. UMATILLA State OR

CORNER DIAGRAM

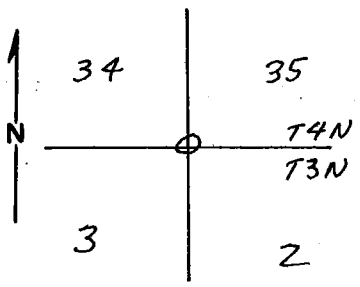

DESCRIBE CORNER MONUMENT FOUND

$2\frac{1}{2}$ " I. PINE W/  $3\frac{1}{2}$ " BLM BR. CAP, MKD →  
5" ABOVE GROUND, GOOD CONDITION

T4N R37E

534	535
53	52
T3N	
1980 2	

DESCRIBE BEARING TREES OR OTHER OFFICIAL ACCESSORIES FOUND

OPT, 27" FIR, ON GROUND, ROTTED FACE, AND ROOT HOLE, BEARS N40°W, 35.0 FT.  
OPT, 31" FIR SNAG, NO MARKS VISIBLE ON OPEN BLAZE, BEARS S40°W, 19.5 FT.  
20" SPRUCE, SCRIBES "T3N R 37E S3BT" VISIBLE ON OPEN FACE, BEARS S51½°W, 12.5 FT.  
10" SPRUCE, SCRIBES "T4N R37E S34BT" VISIBLE ON OPEN FACE, BEARS N18½°W, 42.0 FT.  
16" SPRUCE, PITCHED OVER FACE, BEARS N17¾°E, 36.4 FT.  
16" SPRUCE, PITCHED OVER FACE, BEARS S33¾°E, 18.8 FT.

PHOTO IDENTIFICATION DATA

Photo No. \_\_\_\_\_  
Filed At. \_\_\_\_\_  
Object Ident. \_\_\_\_\_  
Ident. By \_\_\_\_\_  
Signature \_\_\_\_\_

DESCRIBE CORNER LOCATION RELATIVE TO NEAR-BY FEATURES, ALSO HOW TO REACH CORNER

CORNER LIES IN BOTTOM OF SHALLOW DRAW, ABOUT 700' W.  
OF RD. 3715.

PLANE COORDINATE POSITION DATA

State \_\_\_\_\_ Zone \_\_\_\_\_  
X \_\_\_\_\_  
Y \_\_\_\_\_  
Estab. By \_\_\_\_\_  
Agency \_\_\_\_\_

Signature Victor McFaid Title LS Division \_\_\_\_\_ Headquarters \_\_\_\_\_ Date 6-20-86 FS-7100-52 (3/68)

CORNER RECORD (PERPETUATION)

MONUMENT: DESCRIBE NEW MONUMENT SET, OR WORK DONE TO PRESERVE EXISTING MONUMENT

ACCESSORIES : DESCRIBE NEW BT'S WITNESS OBJECTS ETC. ESTABLISHED, OR WORK DONE TO PRESERVE EXISTING EVIDENCE

SET STEEL POSTS ABOUT 3' S. ~~WEST~~ OF CORNER, WITH SIGNS 54-2 AND 54-9  
PAINTED A RED BAND AROUND BT'S.

Work Done By V. McLIND Title LS Date 6-20-86 State Registration No. 934  
or Agency  
Certified Cor. Record Prepared? Yes  No Filed At: Date

REMARKS

Index File No. A-17 T. 3N R. 37E M. WILL Tract or Surv. No. Cor.

LAND CORNER RECORD

1. T 4N R 37E No. 2 17 Cor. Sec. Mer. Will State Oregon (Rectangular) N. F. Umatilla Dist. Pendleton 6

2. Corner Status

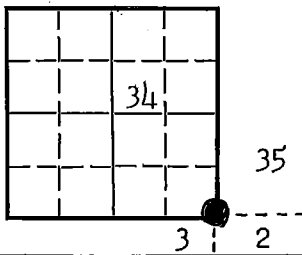

3. Original Description \_\_\_\_\_ Vol. \_\_\_\_\_ Page \_\_\_\_\_ Where Recorded \_\_\_\_\_

4. Description of Corners:  
*Now Monumented*

5. Investigation Notes:

See T3N, R37E (A-17)

( BT NW WF 22" N 40 W 53 IKS  
BT N 12 E 38 IKS ) 1979

7. Photo Identification

Photo No. UM 33 B-6  
Ident. By: \_\_\_\_\_

8. Plane Coordinate Position Data

State \_\_\_\_\_ Zone \_\_\_\_\_

X \_\_\_\_\_

Y \_\_\_\_\_

Estab. By \_\_\_\_\_

Field Book No. \_\_\_\_\_

Where Filed \_\_\_\_\_

9. Evaluation

Authentic \_\_\_\_\_

Needs Verif. \_\_\_\_\_ Monument NO

Re-estab. X Survey \_\_\_\_\_

Land Status \_\_\_\_\_

6. Signed A. Galbraith Title Range Tech. Date 5-15-64

*6*

PERPETUATION RECORD

10. Monument:

11. Accessories

Field Book \_\_\_\_\_ Page \_\_\_\_\_

12. Set By \_\_\_\_\_ Title \_\_\_\_\_

License \_\_\_\_\_ Agency \_\_\_\_\_ Date \_\_\_\_\_

13. Recorded By \_\_\_\_\_ Volume \_\_\_\_\_ Page \_\_\_\_\_  
(Agency)

(Date) (City) (County) (State)

14. Remarks:

Z-17