

OREGON CORNER REFORMATION FORM

Section 4 Township 3N Range 36E
 County Umatilla Date: May 18, 2006

Corner Designation: 3N36C9

1/4 corner to sections 4 and 5, T3N, R36E W.M.
 Umatilla County, Oregon.

Condition Report Only
 Not found
 Remonumented
 Unrecorded
 Surveyed in
 Referenced out

Previous Renewals / Surveys, etc.

Corner originally set by George S. Pershin under contract No. 305 dated September 20, 1878.
 His record reads: Set stone 16 x 12 x 7 for 1/4 sec. cor., A pine, 40 in diam. brs. S. 18 E. 154 lks. dist., A pine, 28 in diam. brs. S. 8 W. 247 lks. dist., Also a house bears S. 52 E.,

Monument and Accessories found: (condition and source)

I found the original stone plainly marked 1/4 S in a small mound of stone at the southwest corner of a plowed field. The remains of the original SW bearing tree were still in place with no scribing visible. A fence runs south from this point and a plow berm runs north.

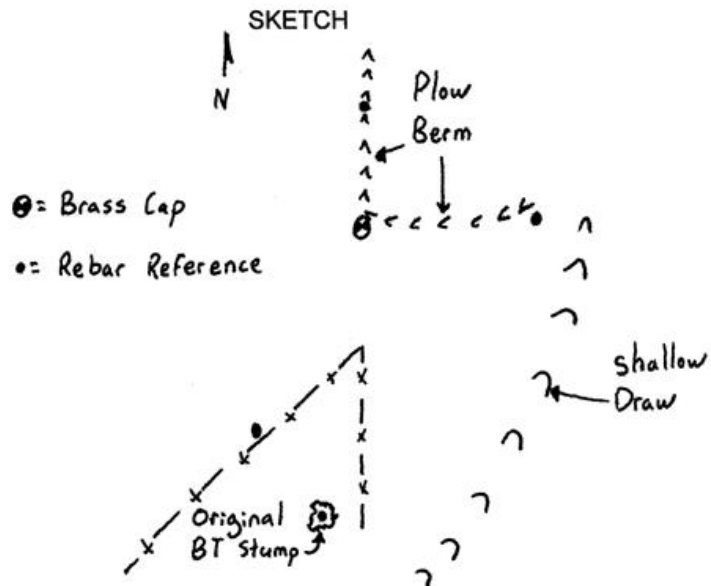
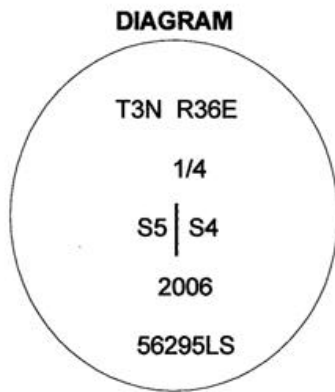

MONUMENT (S) AND ACCESSORIES SET (Procedures and Description)

Set a 1 1/4" x 30" Galvanized Iron Pipe with a 2 1/2" brass cap stamped as shown in the diagram at the position of the original stone. I buried the stone at the foot of the south side of the pipe.

For references, I set four 5/8" by 24" rebars with 1.25" orange plastic caps stamped WTS and 56295LS as described below:

- an iron rebar bears N1°25'18"W, 52.87 feet in the plow berm;
- an iron rebar bears N88°24'07"E, 99.84 feet;
- an iron rebar bears S18°31'37"W, 138.41 feet;
- an iron rebar bears S8°05'07"W, 161.56 feet in the remains of the original bearing tree stump;

This monument and references were set and tied using a Trimble R7/R8 RTK GPS.

Location and comments

Compass Declination

Surveyors Seal

RECEIVED BY:
Umatilla County Surveyor
 Date: 7-06
 Rec'd By: KK
 No. 06-472-B

Firm / Agency
 Witness Tree Surveying
 Address
 P.O. Box G
 Pilot Rock, Or. 97868
 Party Chief
 Stephen K, Haddock

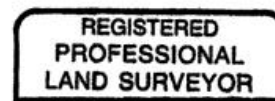

Stephen K. Haddock

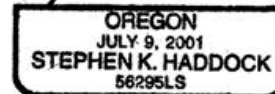

RENEWAL DATE 6-30-07