

OREGON CORNER RESTORATION FORM

COUNTY: Umatilla DATE: 08/01/07

CORNER DESIGNATION: 3N34, Z21. The Southwest Corner of Section 36.

PREVIOUS RENEWALS/SURVEYS ETC.:

Corner was established by Currin and Noland under Special Contract dated May 4, 1887. Previous surveys which established this corner, by Odell under Contract No. 114 and by Moody, Contract No. 164, were superseded by the Currin and Noland survey. Currin and Noland's notes state; "set basalt stone, 12x9x7, 8 inches in the ground, marked with 5 notches on W and 1 notch on E edges".

Corner was not recovered by C.E. Redfield in his survey circa 1918-1919 and was re-established by proportional methods, between the Southeast Corner of Section 36 and the Southwest Corner of Section 35. Redfield's notes do not state what was set as a corner monument.

MONUMENT AND ACCESSORIES FOUND:

Found Redfield's 2 1/4" brass cap on 2" galvanized iron pipe, badly bent to the Southwest, Homly road. Monument has been disturbed by road building equipment.

MONUMENT MARKING DETAIL:

SC
T3N R34E
S35|S36
2007
PLS 1106

MONUMENT SET:

Set a 5/8"x30" iron rebar with a 2" aluminum cap at the base of the bent Redfield monument. The Redfield monument was left in place. Aluminum cap is marked as shown in monument marking detail. Surrounded new monument with earth and stone mound.

New accessories:

- A 5/8"x24" iron rebar with 1 1/4" red plastic cap marked "OR PLS 1106 WA PLS 17372" 3" above ground level on East bank of Homly Road bears North 34° East, 54.8 feet.
 - A 5/8"x24" iron rebar with 1 1/4" red plastic cap marked "OR PLS 1106 WA PLS 17372" 3" above ground level on East bank of Homly Road bears South 32° East, 37.3 feet.
 - A 5/8"x24" iron rebar with 1 1/4" red plastic cap marked "OR PLS 1106 WA PLS 17372" 3" above ground level on West bank of Homly Road bears South 13° West, 42.1 feet.
 - A 5/8"x24" iron rebar with 1 1/4" red plastic cap marked "OR PLS 1106 WA PLS 17372" 3" above ground level on West bank of Homly Road bears North 03° East, 49.2 feet.
- Attached bearing object signs to all rebar accessories. Set steel fence post with "witness" sign attached, 2 feet South of corner monument.

LOCATION AND COMMENTS: Corner is located at the Westerly edge of Homly road in a small ditch.

OREGON STATE PLANE COORDINATE, North Zone, NAD 83(91), International Feet:

N = 743145.81
E = 8708380.85

FIRM: William R. Wells, PLS
P.O. Box 1696
Pendleton, OR 97801

COMPASS DECLINATION: 18° East

Surveyor's Seal

Witnesses: Jason Wells, LSIT

3N34Z21

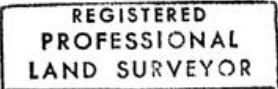

William R. Wells

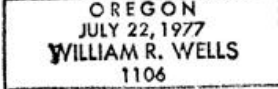

renews 6-30-08