

OREGON CORNER RESTORATION FORM

Section: 35, 36 Township: 3N Range: 33E
 County: Umatilla Date: 12/14/2011

Corner Designation: 3N33Z21

Section corner common to Sections 35, 36, T3NR33E.

	Condition Report Only
X	Not Found
X	Remonumented
	Unrecorded
X	Surveyed In
X	Referenced Out

Previous Renewals / Surveys, etc.

Originally surveyed by Thompson in 1864. He set a post in a mound of earth with charred stake, pits, and a trench.
 In 1887 Currin and Noland set a post in a mound of earth with pits.
 In 1887 Currin and Noland set a post in a mound of earth for the closing corner, with charred stake and pits.
 In 1910 J. Kimbrell found the corner in Private Survey 322 as recorded in Book 2, pg. 179.

Monuments and Accessories Found: (Condition and Source):

A 5/8" iron rebar was found at the corner position. This monument lies at the edge of a field wash in a very unstable location.

Diagram

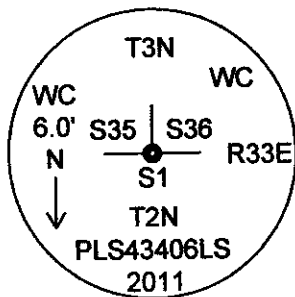

Sketch

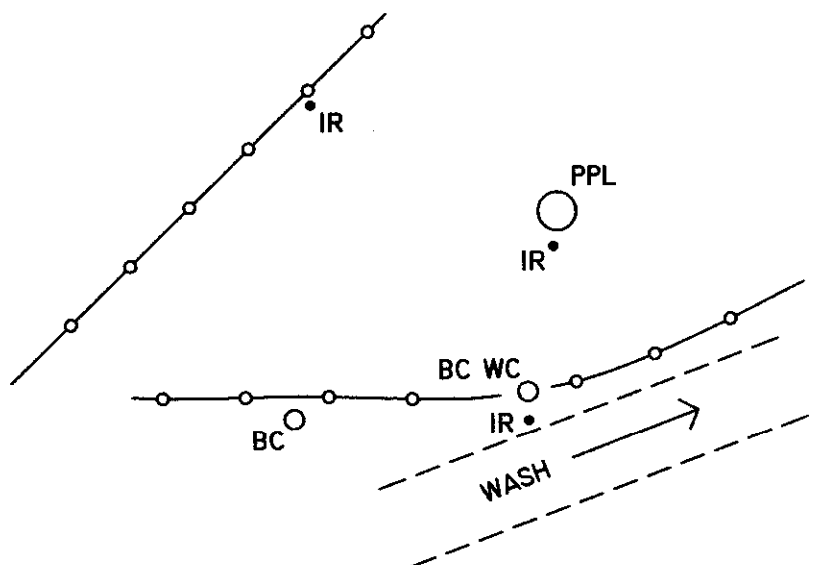

NAD 83/91
 OREGON STATE PLANE NORTH
 INTERNATIONAL FEET

N742641.85
 E8676810.89

Monument(s) Set (Procedures and Description):

A 5/8" x 30" iron rebar w/RPC #43406 at the corner position, on the North edge of a field wash.

References Set:

- A 1 1/8" x 30" galvanized iron pipe with 2 1/2" brass cap witness corner, stamped as shown above, lies N 0° 30' W, 6.00'.
- A 2 1/2" brass cap lies N 88° 30' W, 48.85', at the location of the section corner common to sections 1 and 2 of T2N R33E.
- A 5/8" x 30" iron rebar w/RPC #43406 lies N 33° 30' W, 123.62', at a steel fence post.
- A 5/8" x 30" iron rebar w/RPC #43406 lies N 9° 30' E, 36.52', at a power pole.

Location and Comments:

The corner is located 1 mile West of the intersection of North Cayuse Rd. and Kirkpatrick Rd.

Compass Declination

17° E

Surveyors Seal

REGISTERED
 PROFESSIONAL
 LAND SURVEYOR

Robert D. English

OREGON
 JANUARY 41, 2005
 ROBERT DOUGLAS ENGLISH
 43406LS

RENEWAL DATE: 12/31/13

RECEIVED BY:

Date: 7/10/2012
 Rec'd By: [Signature]
 No. 12-094-c

Firm / Agency

Survey One, LLC.
 P.O. Box 382
 Pendleton, OR 97801
 (541) 276-2055