

OREGON CORNER RESTORATION FORM

Section: 31, 32
County: Umatilla

Township: 3N
Date:

Range: 33E

Corner Designation: 3N33X05

Quarter corner common to Sections 31, 32, T3NR33E.

_____	Condition Report Only
<u> X </u>	Not Found
<u> X </u>	Remonumented
_____	Unrecorded
<u> X </u>	Surveyed In
<u> X </u>	Referenced Out

Previous Renewals / Surveys, etc.

Originally surveyed by Chaplin in 1864. He set a 17" x 12" x 8" stone.

In 1871 Moody set a 14" x 10" x 10" stone

In May 1887 Currin and Noland set a 12" x 10" x 8" stone, with pits to the North and South and a mound of earth.

Monuments and Accessories Found: (Condition and Source):

None.

Diagram

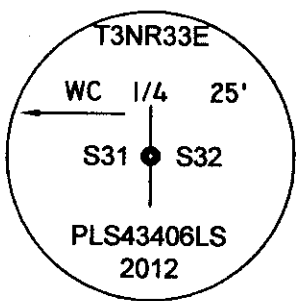

Sketch

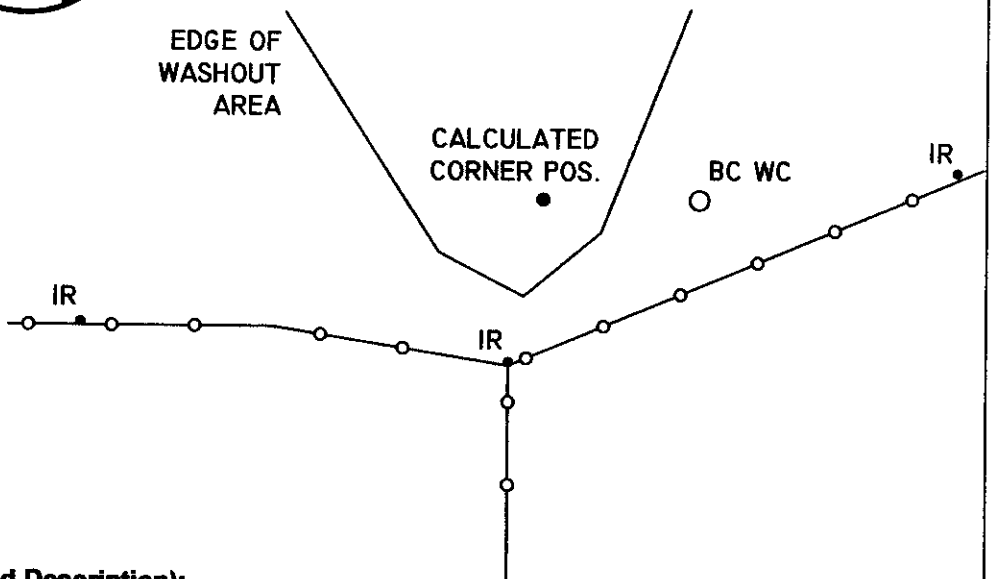

NAD 83/91
OREGON STATE PLANE NORTH
INTERNATIONAL FEET

N744873.99
E8655661.05

Monument(s) Set (Procedures and Description):

A 1 1/8" x 30" galvanized iron pipe with 2 1/2" brass cap witness corner, stamped as shown above, lies East, 25.01'.

References Set:

A 5/8" x 30" iron rebar w/RPC #43406 lies N 86° 30' E, 218.11', at a 6" iron post.

A 5/8" x 30" iron rebar w/RPC #43406 lies S 12° 20' W, 26.73', at a steel fence post.

A 5/8" x 30" iron rebar w/RPC #43406 lies S 75° W, 71.21', at a steel fence post.

Location and Comments:

The corner is located 0.6 miles, M/L, North East of the intersection of Adams Rd. and McCormach Rd. in a canyon between active wheat fields to the South and a CRP field to the North.

Compass Declination

17° E

Surveyors Seal

REGISTERED
PROFESSIONAL
LAND SURVEYOR

Robert Douglas English

OREGON
JANUARY 11, 2005
ROBERT DOUGLAS ENGLISH
43406LS

RENEWAL DATE: 12/31/13

RECEIVED BY:

Date: 7/10/2012
 Rec'd By: S. Ples
 No. 12-094-c

Firm / Agency

Survey One, LLC.
 P.O. Box 382
 Pendleton, OR 97801
 (541) 276-2055