

OREGON CORNER RESTORATION FORM

Section 10 Township 3N Range 33E

J-13

County Umatilla Date 11-8-85

CORNER DESIGNATION

- Condition Report Only
- Not Found
- Renewed
- Unrecorded
- Surveyed In
- Referenced Out

Previous Renewals/Surveys, etc. \_\_\_\_\_

Corner set by J.R. Gray in 1954, County No. Q-526-A; Krumbein found railroad spike in 1981, County No. S-153-B

Monument(s) & Accessories Found: (Condition and Source)

Railroad spike at intersection of County road and North-South running plowlines

Monument Detail

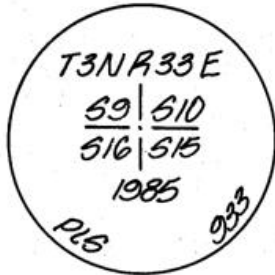

Sketch

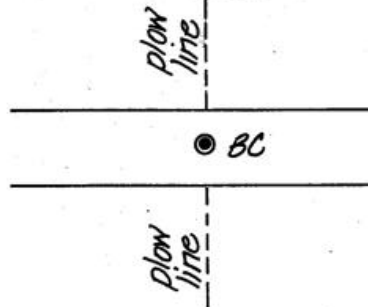

Monument Set (Procedures and Description)

2 1/2" Brass Cap on 1 1/2" galvanized pipe set at position of railroad spike as per County No. S-153-B and set 8" below surface

New Accessories

None

Location & Comments

Surveyor's Seal

RECEIVED BY  
 Umatilla County Surveyor  
 Date 6-26-86  
 Rec'd By KA  
 No. 86-76 R

Compass Declination \_\_\_\_\_  
 Firm/Agency Krumbein Engineering Ltd  
 Address 361 S.E. Second Pendleton, Oregon 97801  
 Party Chief R. Panches  
 Notes \_\_\_\_\_  
 Witness S. Carlson

