

OREGON CORNER RESTORATION FORM

COUNTY: Umatilla DATE: 5/7/15

CORNER DESIGNATION: The West One-Quarter Corner of Section 17, Township 3 North, Range 31 East, L-5.

PREVIOUS RENEWALS/SURVEYS ETC.: Corner originally established by D.S. Payne, under Contract No. 100, dated 8/1/1861, notes state: Set charred stake with mound trench and pits as per instrs. for 1/4 sec corner. In Survey No. 06-462-C, a point in Peebler Road East-West with a dim field line extending North was held as the corner point for proportioning but not monumented.

MONUMENT AND ACCESSORIES FOUND: None. The field line extending North in 2006 is no longer visible.

MONUMENT MARKING DETAIL:

T3N R31E
1/4
S18|S17
1976
PLS 54657

MONUMENT SET: At the corner position observed and held in Survey No. 06-462-C, I set a 2 3/8" brass cap on a 1 1/4" x 30" galvanized iron pipe with top 12" below road level marked as shown in "Monument Marking Detail".

From which:

- A silver deep-1 magnet, buried 20" in the ground, bears North 59° East, 29.5 feet.
 - A pink deep-1 magnet, buried 20" in the ground, bears South 59° East, 28.1 feet.
 - A blue deep-1 magnet, buried 20" in the ground, bears South 60° West, 26.0 feet.
 - An orange deep-1 magnet, buried 20" in the ground, bears North 55° West, 34.0 feet.
- Buried bearing object tags with all magnets.

LOCATION AND COMMENTS: At point in Peebler Road, East-West.

OREGON STATE PLANE COORDINATE, North Zone, NAD 83(91), International Feet:

N = 759939.89
E = 859939.89

FIRM: Wells Surveying
P.O. Box 1696
Pendleton, OR 97801

COMPASS DECLINATION: 18° East Surveyor's Seal

Witnesses: Jason Wells, PLS
Dean Roy

/3N31L5

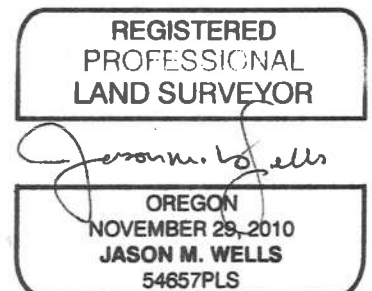

15-052-C

RENEWS: 6-30-16