

OREGON CORNER RESTORATION FORM

COUNTY: Umatilla DATE: 3/27/15

CORNER DESIGNATION: The West One-Quarter Corner of Section 15, Township 3 North, Range 31 East, L-13.

PREVIOUS RENEWALS/SURVEYS ETC.: Corner originally established by D.S. Payne, under Contract No. 100, dated 8/1/1861, notes state: Set charred stake with mound trench and pits as per instrs. for 1/4 sec corner.

MONUMENT AND ACCESSORIES FOUND: None.

MONUMENT MARKING DETAIL:

T3N R31E
1/4
S16|S15
2015
PLS 54657

MONUMENT SET:

Held the projected centerline intersection of Moore Road East and South as best remaining evidence of original corner location and set a 2 3/8" brass cap on a 1 1/4" x 30" galvanized iron pipe, with top 18" below ground level, in North South farmed field line, stamped as shown in "Monument Marking Detail".

From which:

A silver deep-1 magnet buried 20" in the ground, bears North 51° East, 27.6 feet.

A pink deep-1 magnet buried 20" in the ground, bears South 30° East, 66.6 feet.

A blue deep-1 magnet buried 20" in the ground, bears South 55° West, 29.2 feet.

An orange deep-1 magnet buried 20" in the ground, bears North 38° West, 28.0 feet.

Buried bearing object tags with magnets.

LOCATION AND COMMENTS: At the projection of the centerline of Moore Road East and South, in North-South farmed field line.

OREGON STATE PLANE COORDINATE, North Zone, NAD 83(91), International Feet:

N = 759982.99

E = 8602161.53

FIRM: Wells Surveying

P.O. Box 1696

Pendleton, OR 97801

COMPASS DECLINATION: 18° East

Surveyor's Seal

Witnesses: Jason Wells, PLS

Dean Roy

/3N31L13

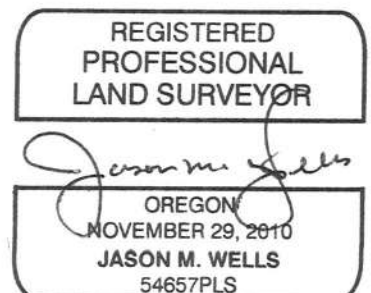

RENEWS: 6-30-16

15-052-c