

OREGON CORNER RESTORATION FORM

COUNTY: Umatilla DATE: 04/10/15

CORNER DESIGNATION: The Northwest Corner of Section 9, Township 3 North, Range 31 East, E-9.

PREVIOUS RENEWALS/SURVEYS ETC.: Corner originally established by D.S. Payne, under Contract No. 100, dated 8/1/1861, notes state: Set charred stake with mound trench and pits as per instructions for cor to secs 4, 5, 8 & 9. Dave Krumbein, on Survey No. S-53-B, indicates a fence line intersection in 1979. Inspection of 1956 Farm Service Photographs indicates no fence features in 1956..

MONUMENT AND ACCESSORIES FOUND: None

MONUMENT MARKING DETAIL:

T3N R31E
S5|S4
S8|S9
2015
PLS 54657

MONUMENT SET: To re-establish this corner, I held the record proportioned latitude between the West one-quarter Corners of Sections 4 and 9 and shifted latitude point due West to intersect North-South field line. At the re-established corner position, set a 2 3/8" brass cap on a 1 1/4" x 30" galvanized iron pipe with top 20" below ground level, marked as shown in "Monument Marking Detail".

From which:

- A silver deep-1 magnet, buried 20" in the ground, bears North 48° East, 33.0 feet.
- A pink deep-1 magnet, buried 20" in the ground, bears South 43° East, 37.2 feet.
- A blue deep-1 magnet, buried 20" in the ground, bears South 37° West, 33.6 feet.
- An orange deep-1 magnet, buried 20" in the ground, bears North 46° West, 30.3 feet.

Buried bearing object tags with magnets. Set a steel fence post with witness sign attached 2 feet West of monument.

LOCATION AND COMMENTS: Located in a North-South field line.

OREGON STATE PLANE COORDINATE, North Zone, NAD 83(91), International Feet:

N = 767953.33
E = 8596733.08

FIRM: Wells Surveying
P.O. Box 1696
Pendleton, OR 97801

COMPASS DECLINATION: 18° East

Surveyor's Seal

Witnesses: Jason Wells, PLS

Dean Roy

/3N31E9

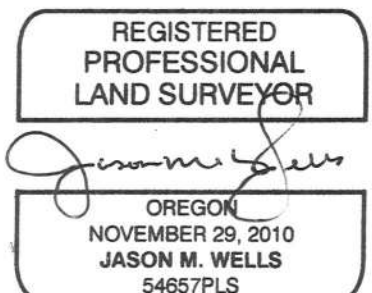

15-052-C

RENEWS: 6-30-16