

OREGON CORNER RESTORATION FORM

Section 1 Township 3N Range 29E
 County Umatilla Date: 05-09-02

Corner Designation: 3N29A25

Condition Report Only
 Not Found
 Remonumented
 Unrecorded
 Surveyed In
 Referenced Out

Previous Renewals / Surveys, etc.

Monument set by survey 98-213-C.
 Survey 01-146-B records found brass cap at this corner location.

Monument and Accessories Found: (condition and source)

Found a brass cap stamped as shown in the diagram.

SKETCH

DIAGRAM

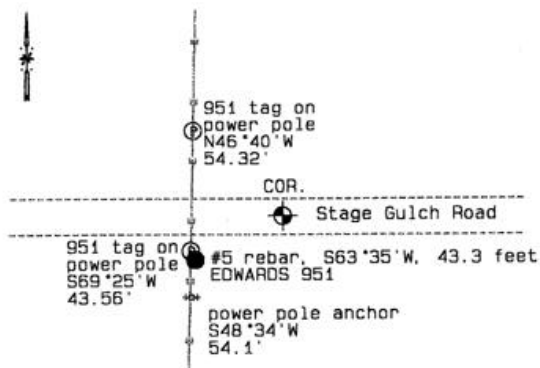
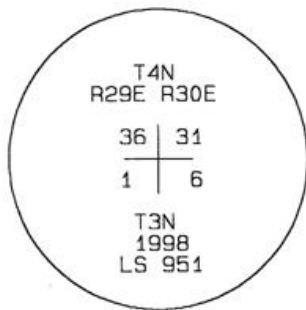

MONUMENT (S) AND ACCESSORIES SET (Procedures and Description)

None.

REFERENCES SET:

None.

Made GPS tie to TRI Station Echo.	Oregon State Plane Coord. - North Zone
Latitude 45°46'38.60229"N	Northing 772526.73
Longitude 119°07'19.64594"W	Easting 8553647.02
NAD 83 (1991)	Ortho Height 812.21
	Ellipsoidal Height 742.96

Location and Comments

Compass Declination
20°E

Surveyors Seal

From the junction of S. Ash Road and Stage Gulch Road in Stanfield, go east 3.5 miles.

REGISTERED
 PROFESSIONAL
 LAND SURVEYOR

RECEIVED BY:

Firm / Agency

David L. Haddock

Date: 6-02
 Rec'd By: DR
 No. 02-169-9

Haddock Surveying
 P. O. Box 1574
 Pendleton, OR 97801
 (541) 276-2174

OREGON
 JULY 12, 1968
 DAVID L. HADDOCK
 852